

# HANSE 410 SALES MANUAL

Andreas Unger



*Hanse*   
BREAKING RULES . SETTING TRENDS

## Introduction

After the great success of our Hanses 460 and 510 we are proud to present you the newest product from our cooperation with Berret-Racoupeau.

Especially with a boat under 12 metres, it is a special challenge to realise everything at the same time: the market's demands, the sales department's requirements and – not to forget – the product management's vision.

But now it's done, the entire development team of Berret-Racoupeau and HanseYachts did a tremendous job.

berret • ra(oupeau

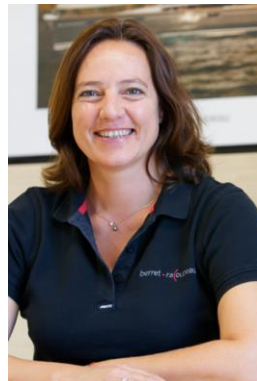

Isabelle Racoupeau



Olivier Racoupeau



As proven with the Hanses 460 and 510, Olivier and his team have understood perfectly what our customers demand and enjoy.

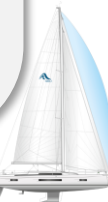

## What's making it special?

Climate-neutral sailing is the result of a sustainable technical design:

- Fully electric propulsion with up to 55 NM reach
- Fuel cell
- Solar panels
- Sails from recycled material

Sustainable vacation on water

Enjoy the autarchy



Excellent exterior design & features

- Familiar design like the bigger new Hanse models
- Largest cockpit in its class incl. double cockpit table
- Wetbar with BBQ in the cockpit

Interior:

- Large owner's cabin
- Large saloon
- Unique layout options for the interior
- The biggest fridge capacity possible in this class

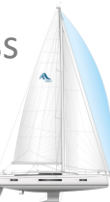































## Hull shape

We have transferred the successful lines of the Hanses 460 and 510 to a 41-foot yacht. As with her big sisters, we have again focused on a narrow waterline with minimal wetted area in the new Hanse 410. This is ensured by a balanced mix of hard and soft chines. The wide stern in combination with the negative bow make the yacht a strong downwind boat. But also on upwind courses the hull shows its potential due to the narrow waterline. Our new Hanse 410 is a true allround talent.

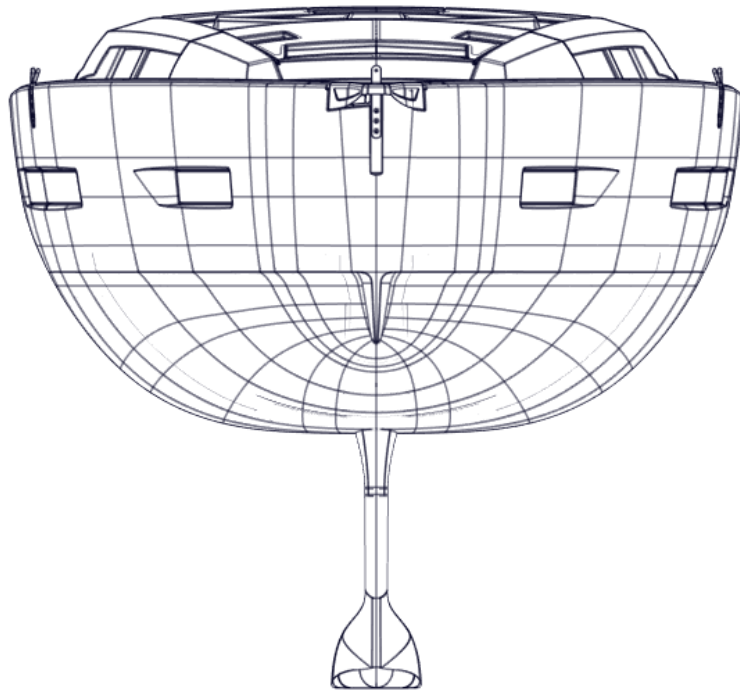

The proven concept known from the Hanses 460 and 510 is perfect for the Hanse 410 as well.

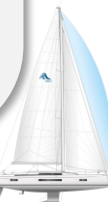

## Hull shape

The reverse wave-piercing bow prevents pitching in a rising wind, while the hard chine starts right at the bow, thus breaking the wave. So, when the bow dips, less water reaches the deck which results in drier sailing.

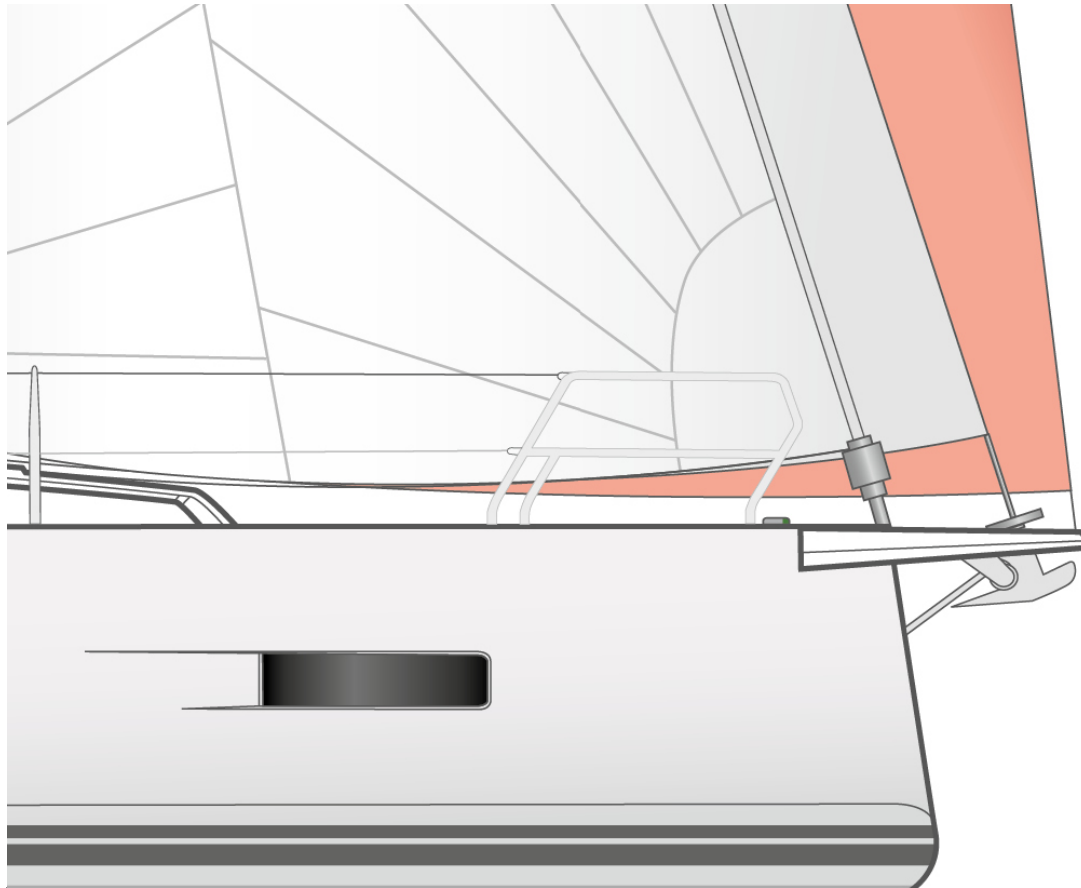

The hull of a wave-breaking boat has less buoyancy in the forward area. Thus, the hull pushes through the water when it hits a wave instead of riding over the top. This makes the boat glide through the water much smoother than conventional designs. That's what he have been intending.





## Hull shape

The chines at the bow allow for 156 mm more beam without extending the waterline. This provides for ample space in the forward cabin with a luxurious bed.

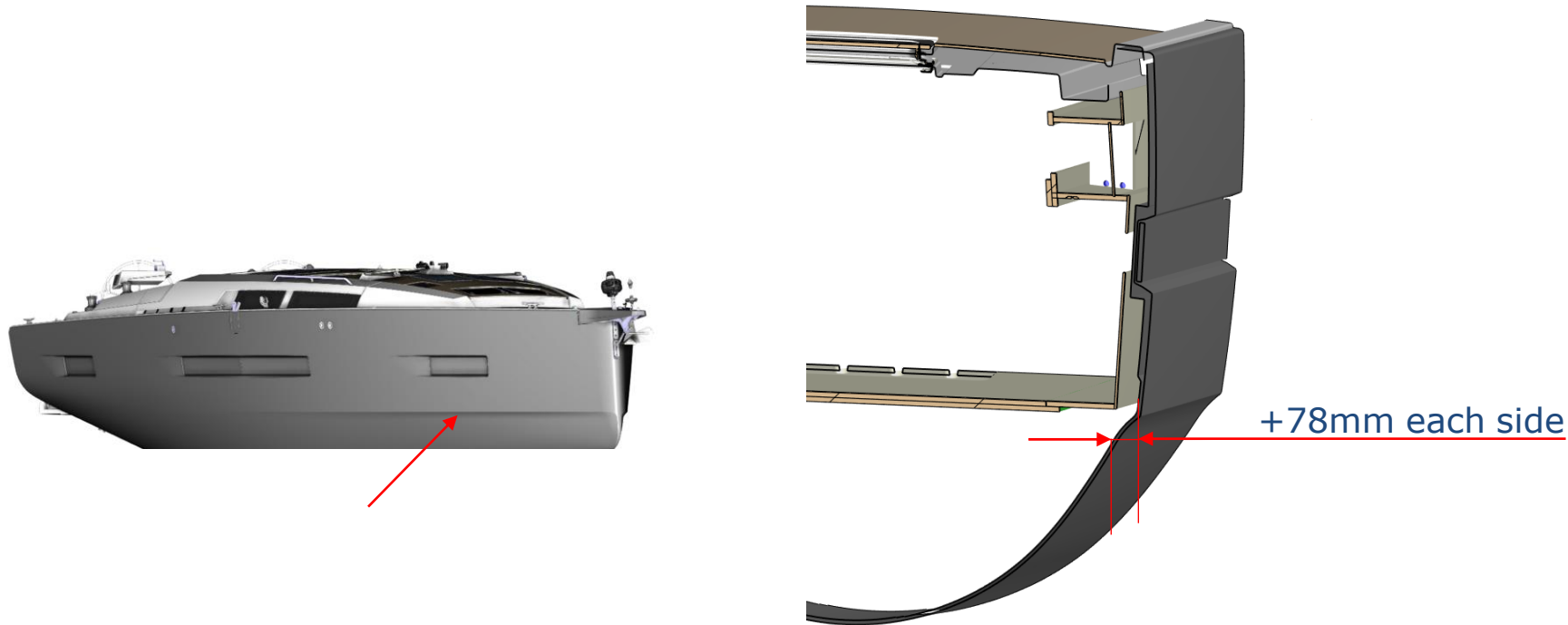

The chines start right at the bow, thus also acting as perfect wave deflectors.

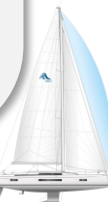



## Cockpit layout

Ergonomics is key: from his position, the helmsman is in reach of everything he needs to control the yacht even single-handedly. All lines are led back to the helm, winches, jammers, etc. are less than an arm's length away. And the secondary winch is mounted on the coaming at a comfortable working height so that it is possible to trim the flying head sails.

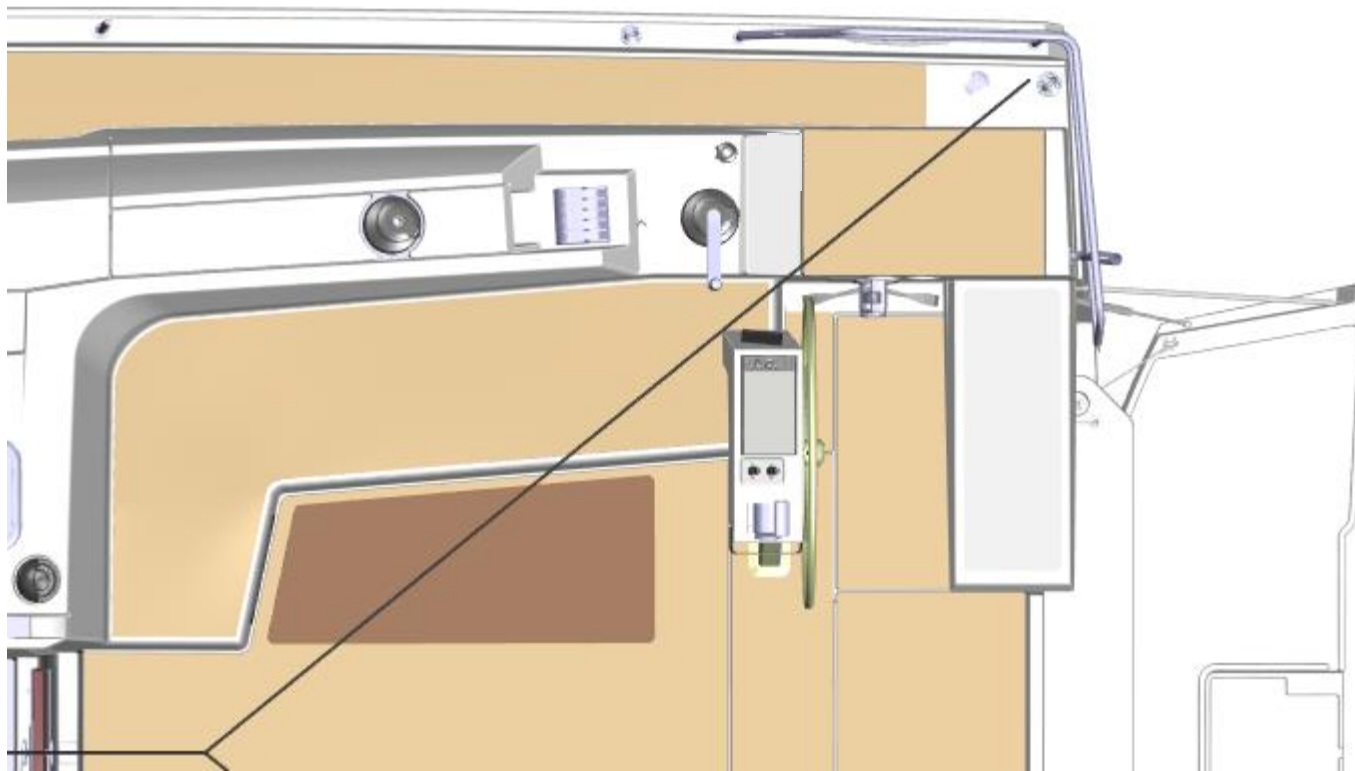

Not having to leave the helm for setting the sails is a huge plus for safety.





## Cockpit layout

Ergonomics have been also paramount for the design of the bathing platform. We have created a beautiful access to our favourite element, which is safe and comfortable for everyone thanks to the automatically folding step.

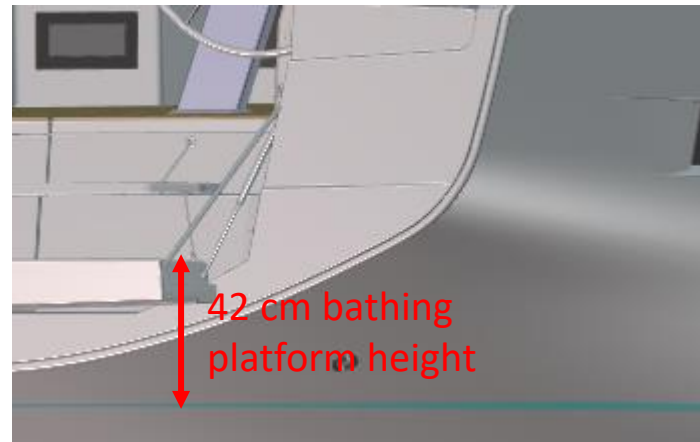
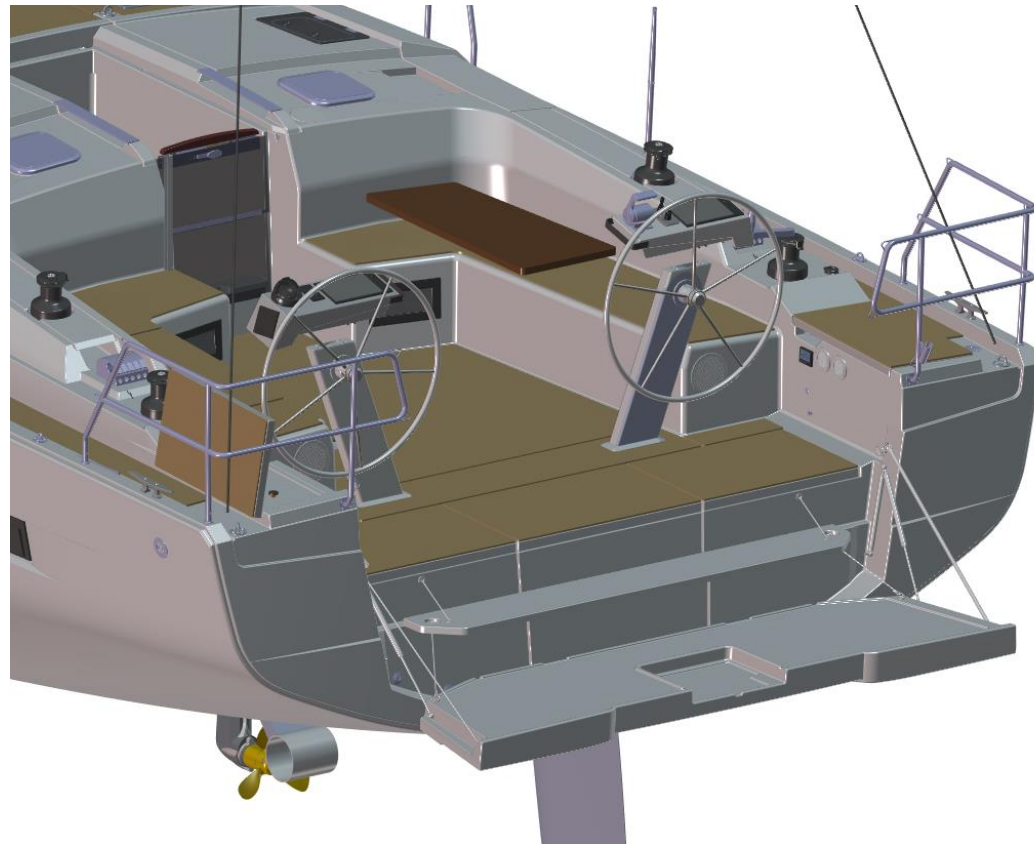

With 2.69 by 0.68 metres, the measurements of the bathing platform are utterly comfortable.

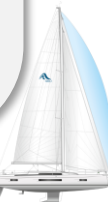

## Cockpit layout

We have also provided storage space for a life raft. The container is centrally located in the cockpit behind the steering system.

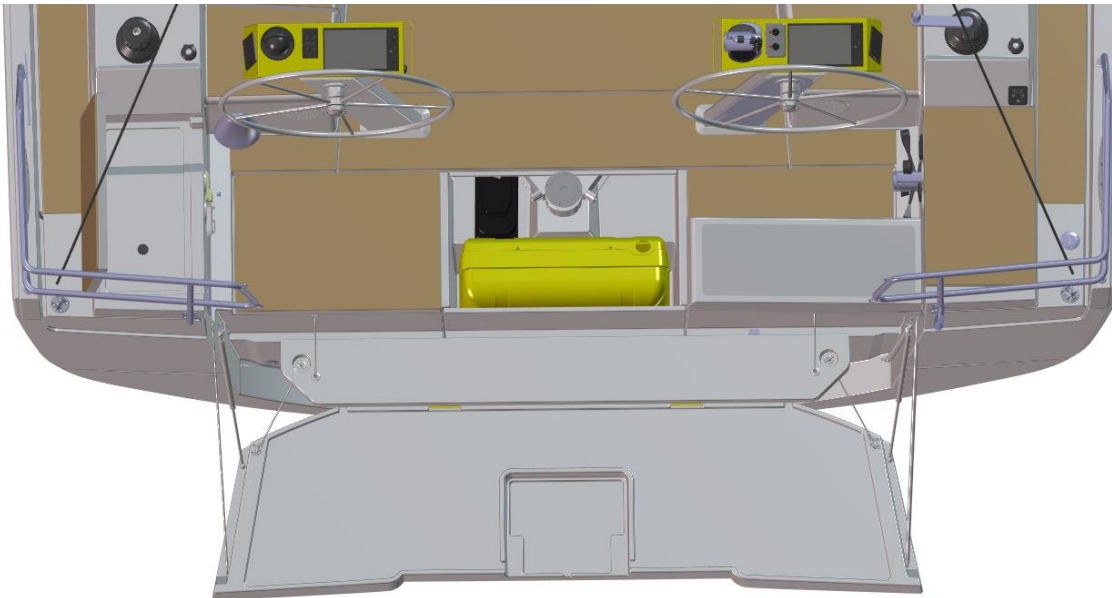

Many current life rafts fit into the storage space. Here is an overview:

- Plastimo Transocean ISO 9650-1
- Zodiac Eversafe 6P
- Ocean ISO 6P
- Crewsaver ISO 6P
- Seatec offshore 6P
- Arimar Atlantic P Container 6P

Zodiac Eversafe 8P

Attention: option only possible without wetbar

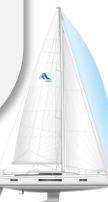



## Deck layout

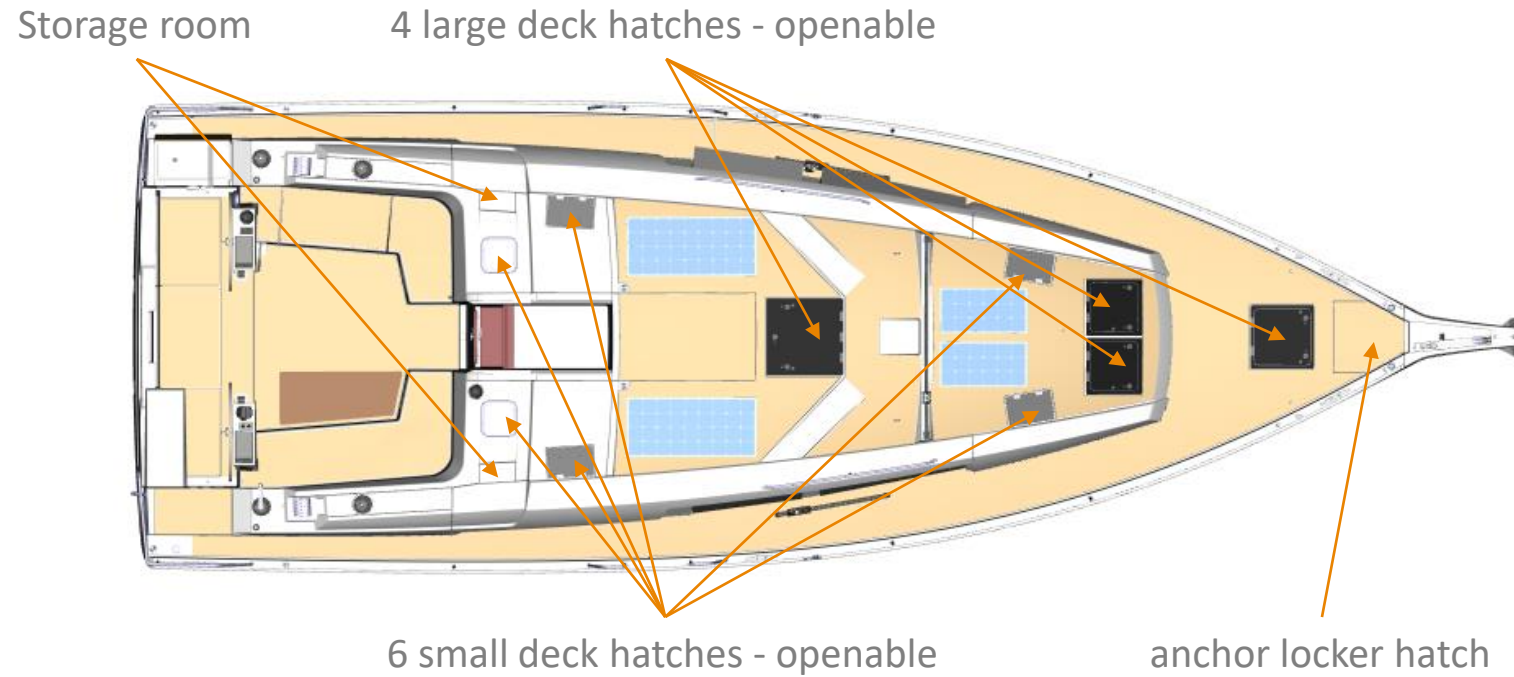

We are proud to set a new benchmark again, as our Hanse 410 offers the most deck hatches in its class.



## Deck layout

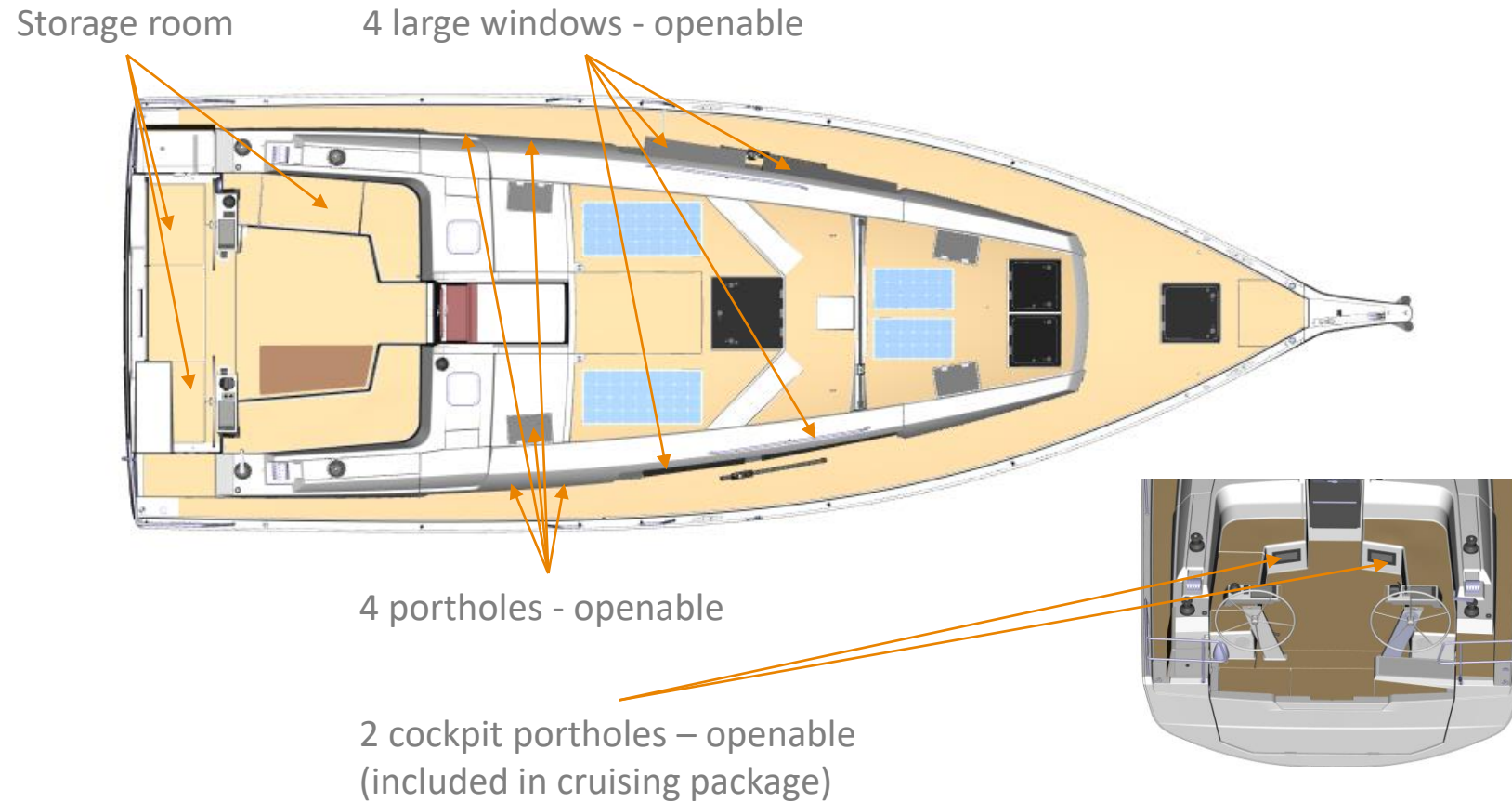

We have succeeded in transferring the proven cross-ventilation function already known from the 460 and the 510 to our new Hanse 410.





## Ventilation concept

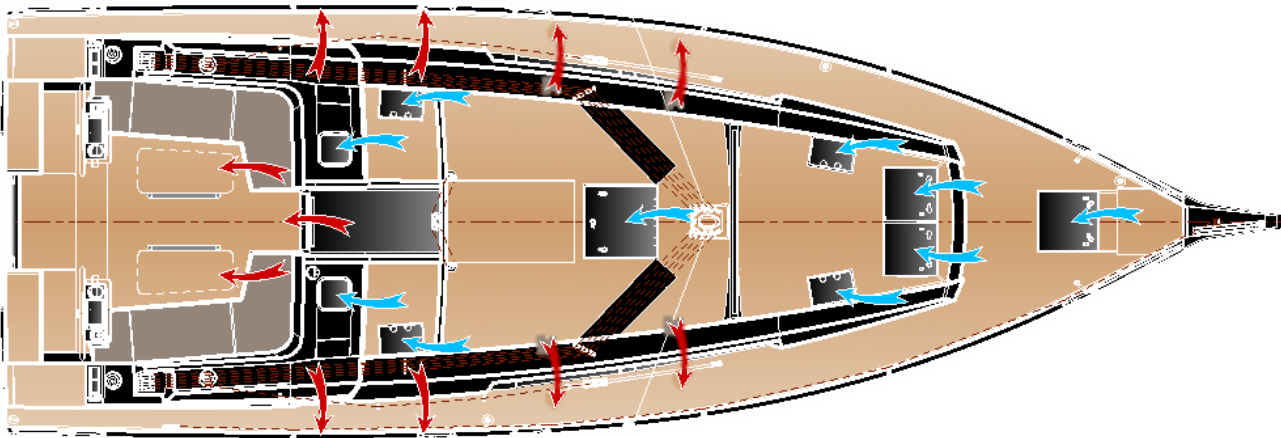
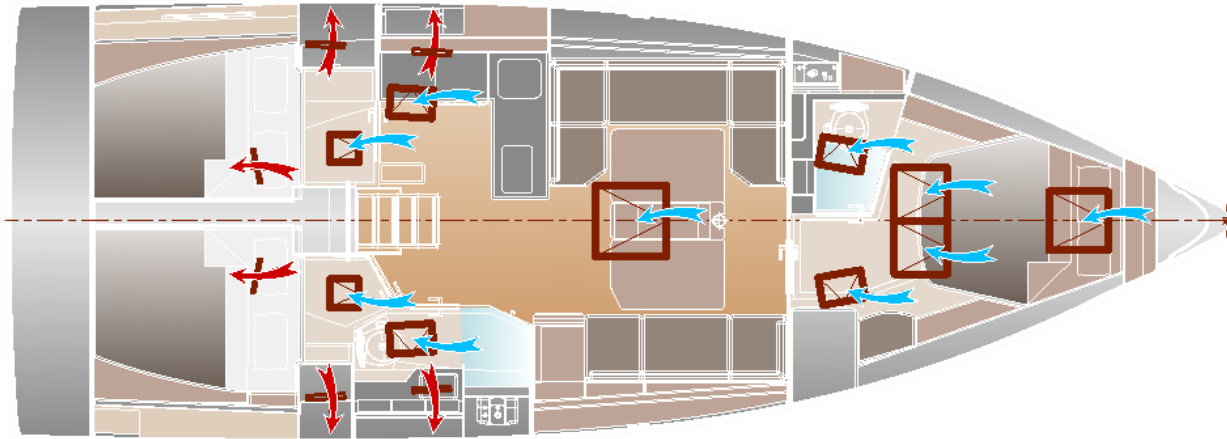

Nothing beats natural ventilation on board. This cannot be replaced but supplemented by air conditioning. That is why we placed so much emphasis on realising this concept on the smaller boat as well.

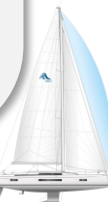



## Interior



This interior is well thought-out and a cosy home.





# Interior

## Layout separation

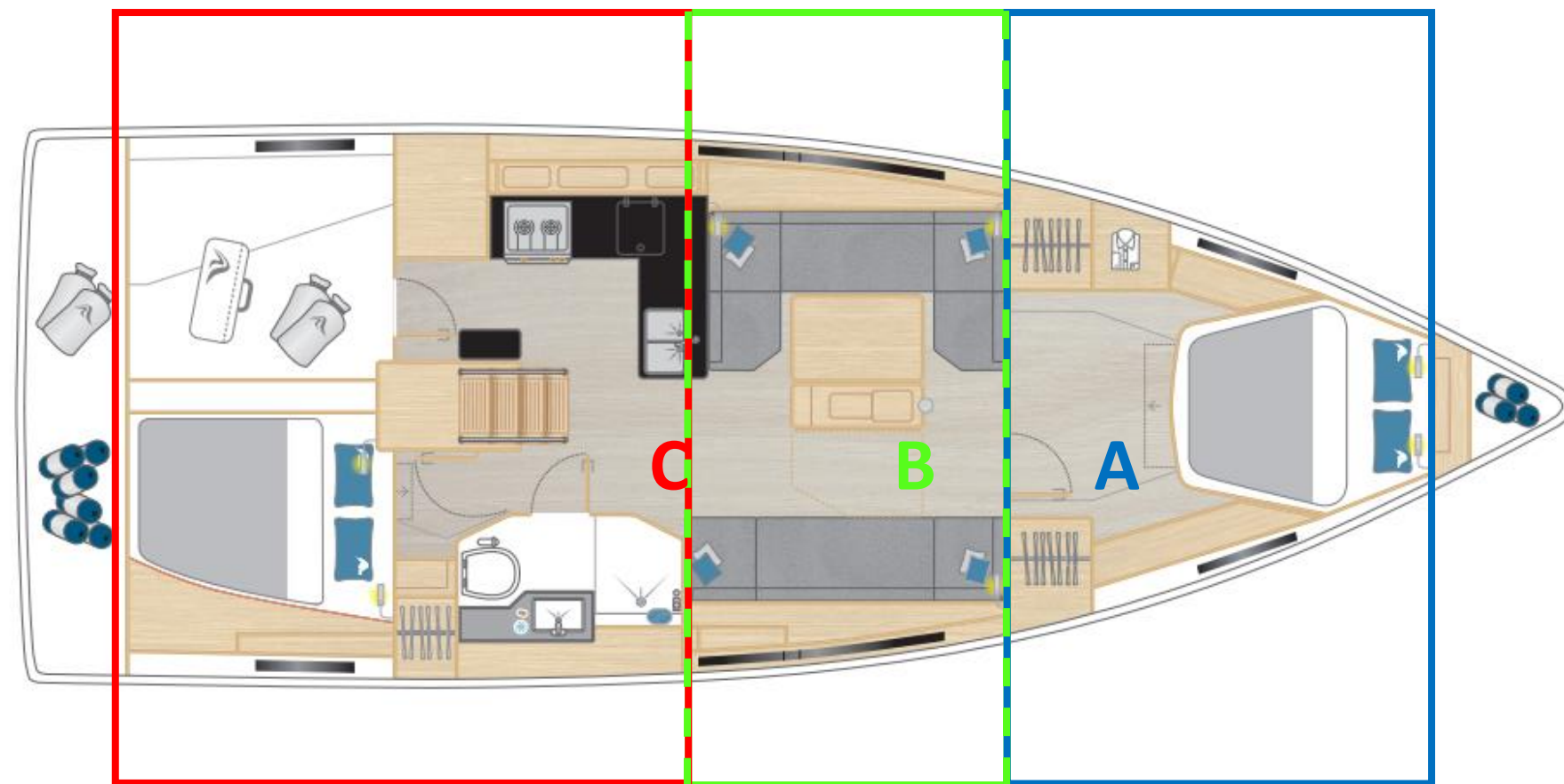

We have restructured the layout logic. It no longer refers to rooms but to functional areas. This means more freedom and less restrictions.



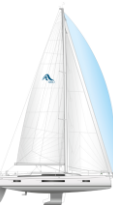



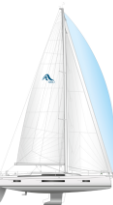

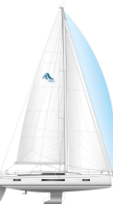



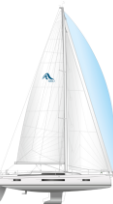

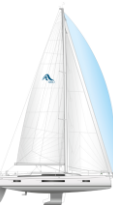





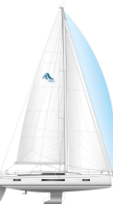



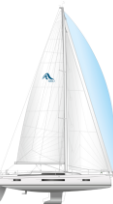

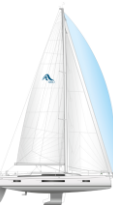



## Interior

Layout:

A1: Master cabin with island double berth and storage space

B1: Saloon with large dining area on port and sofa on stb

C1: Large L-galley and storage space on port. Head with separate shower stall, aft cabin with double berth, locker and storage on stb.

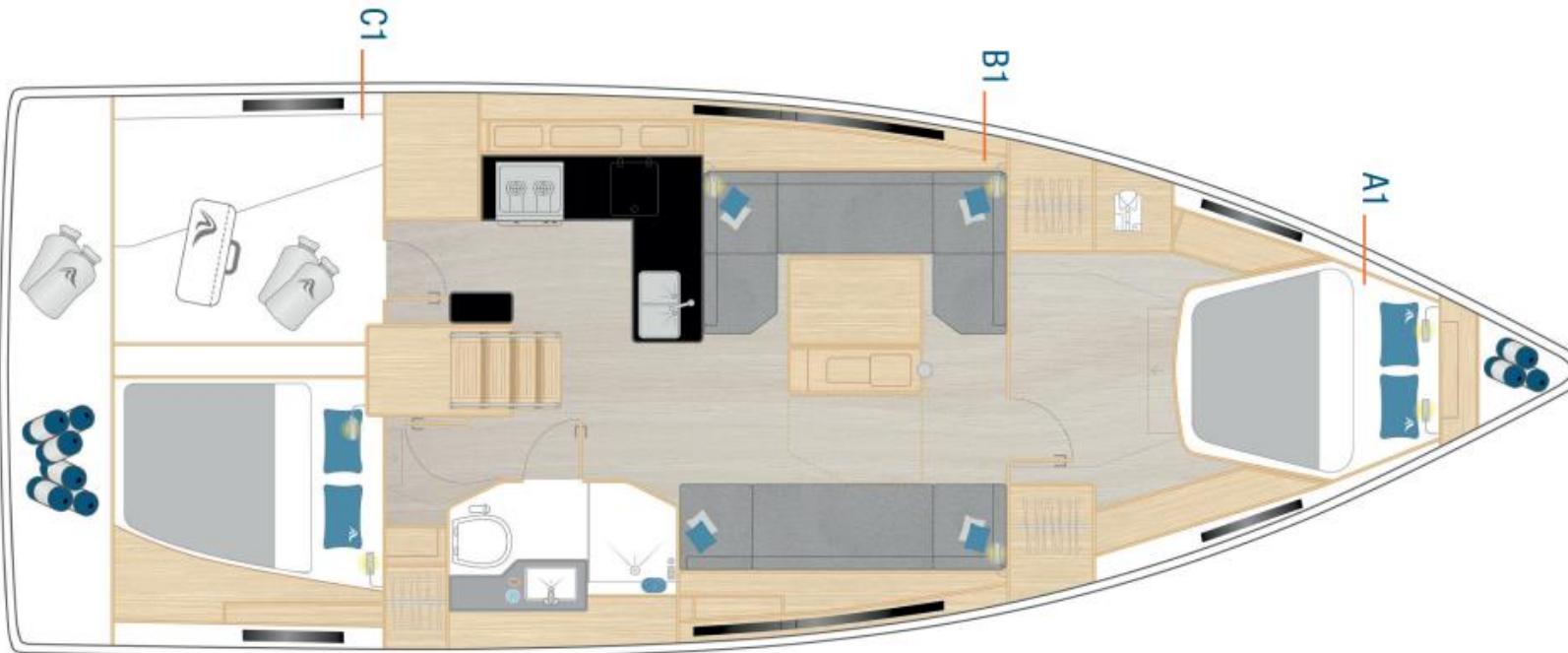

Here you can see our standard layout with the big galley



## Interior

Layout:

A2: Master cabin with island double berth, storage space, vanity desk and seating

B2: Saloon with large dining area on port and sofa with chart table on stb

C1: Large L-galley and storage space on port. Head with separate shower stall, aft cabin with double berth, locker and storage on stb.

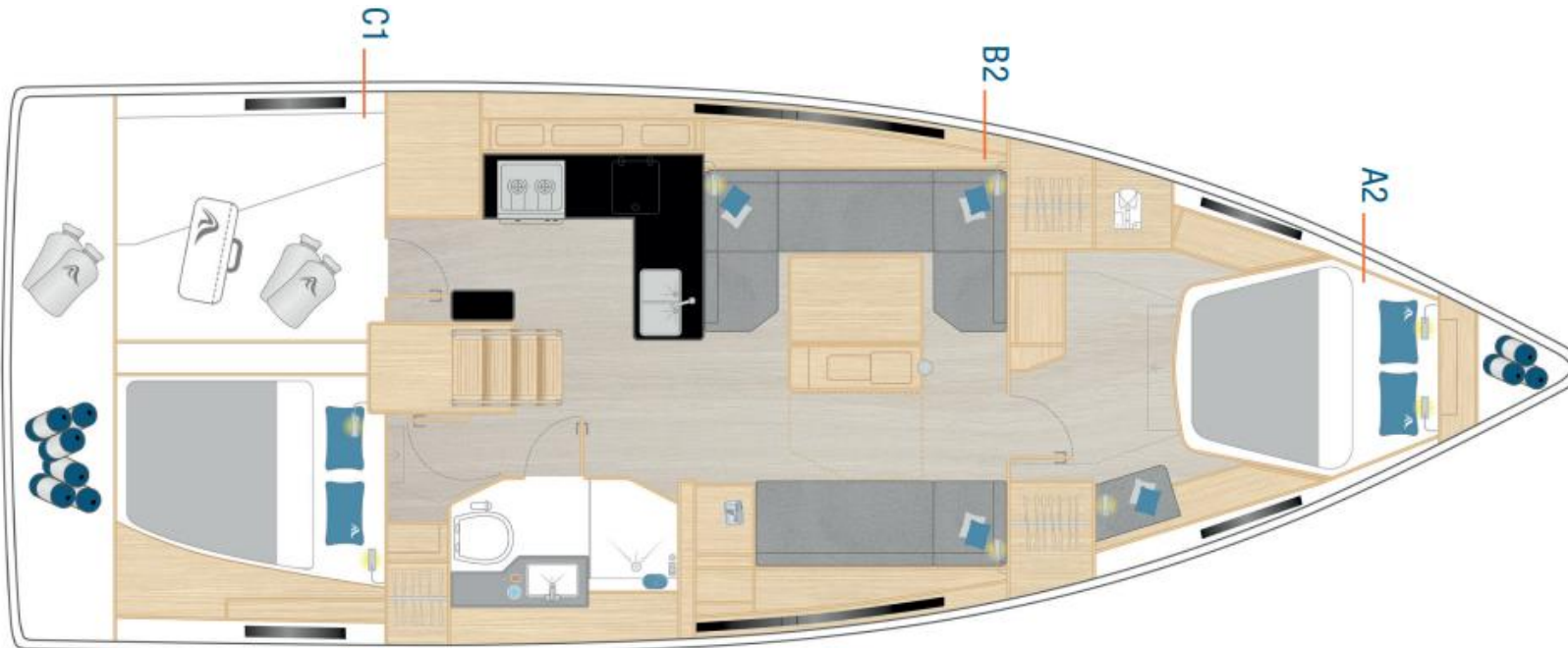

Generously equipped owner's cabin with all the refinements, plus a gigantic kitchen with room for an additional double drawer refrigerator and the classic chart table.





## Interior

Layout:

A3: Master cabin with island double berth, storage space and separate head

B3: Saloon with large dining area on port and sofa with multi-function unit, navigation console and storage on stb

C2: L-galley on port and head with separate shower stall on stb, 2 aft cabins with double berth, locker and storage.

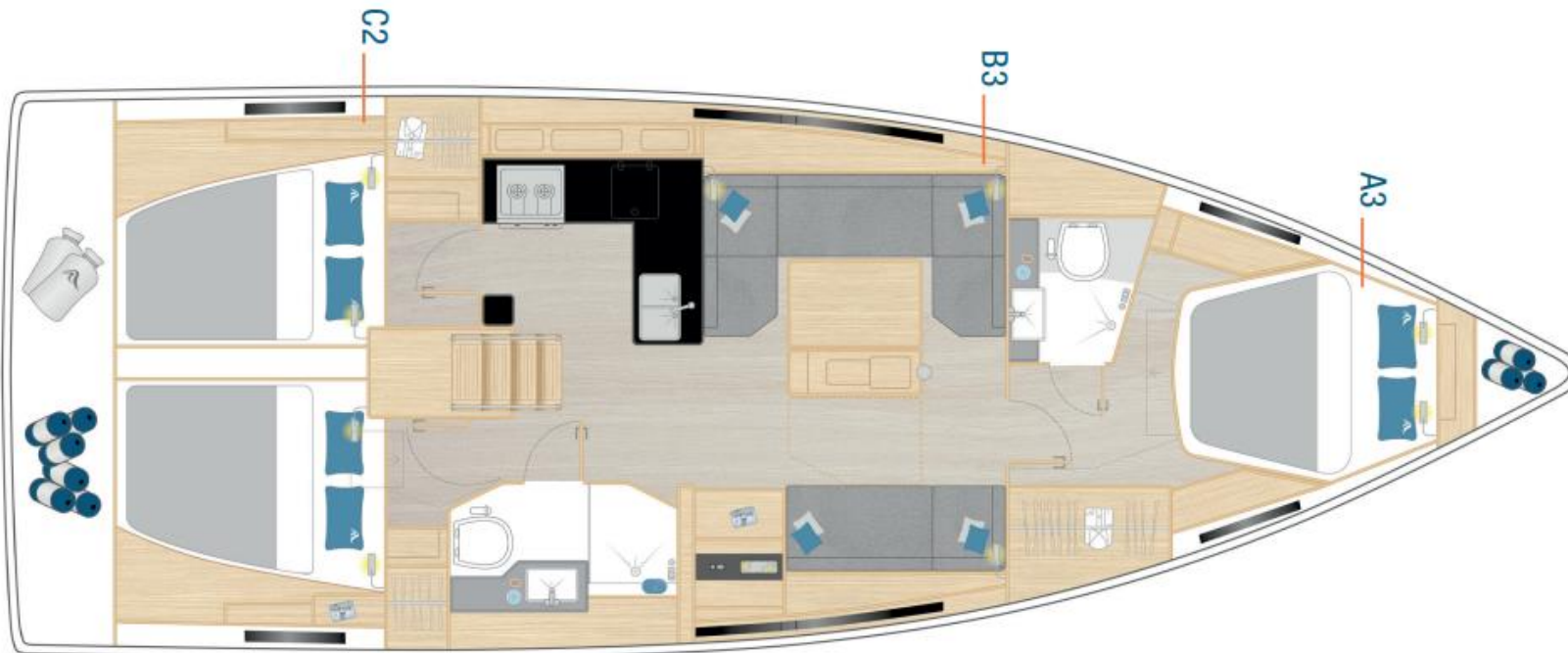

Three cabins two heads, perfect layout for a nice törn with friends. For this you can use the additional drawer fridge in the multifunction unit very well.



## Interior

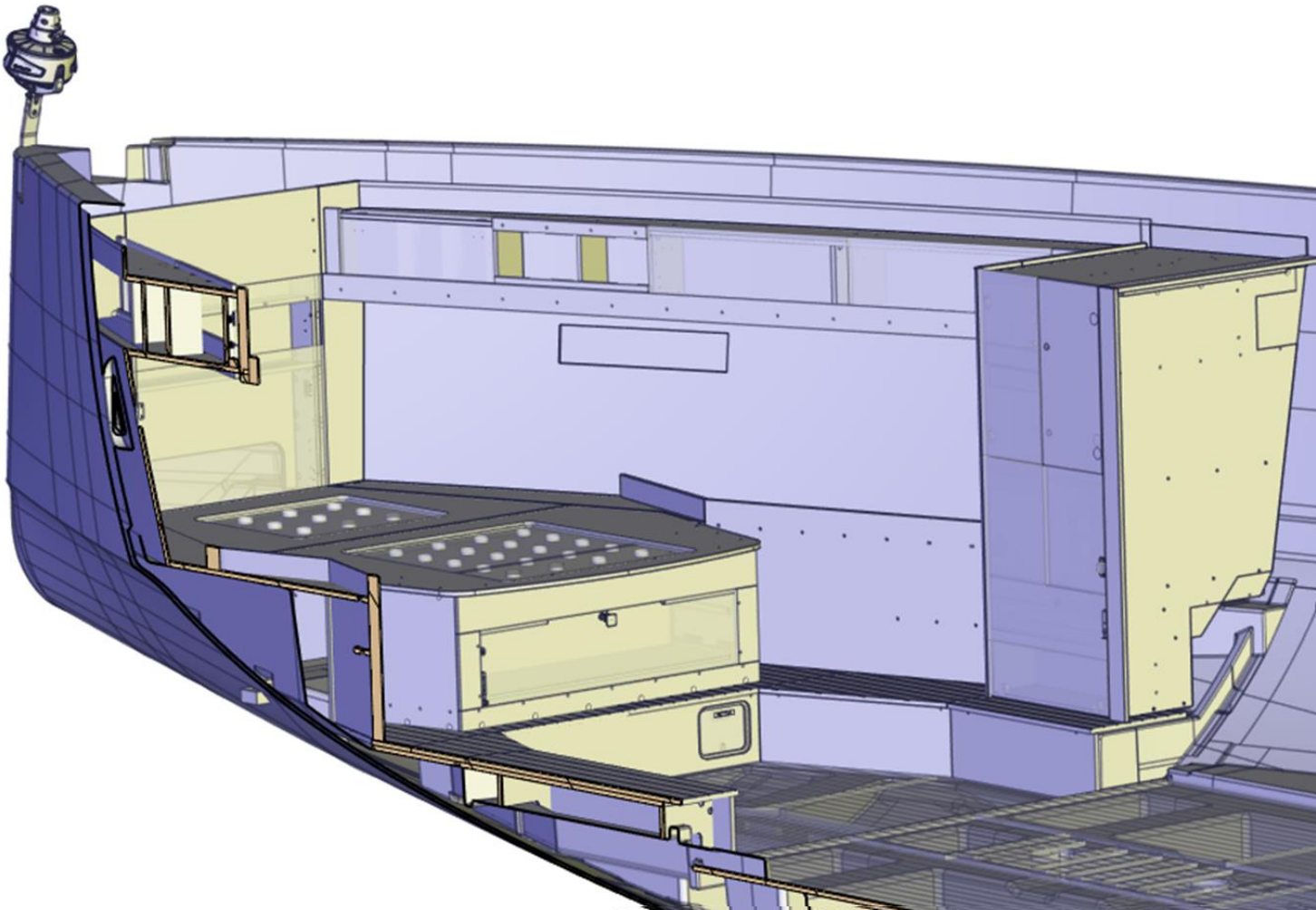

This is the A1 cabin including the Flagship package upgrade (more details on page 77 ff.)





## Interior

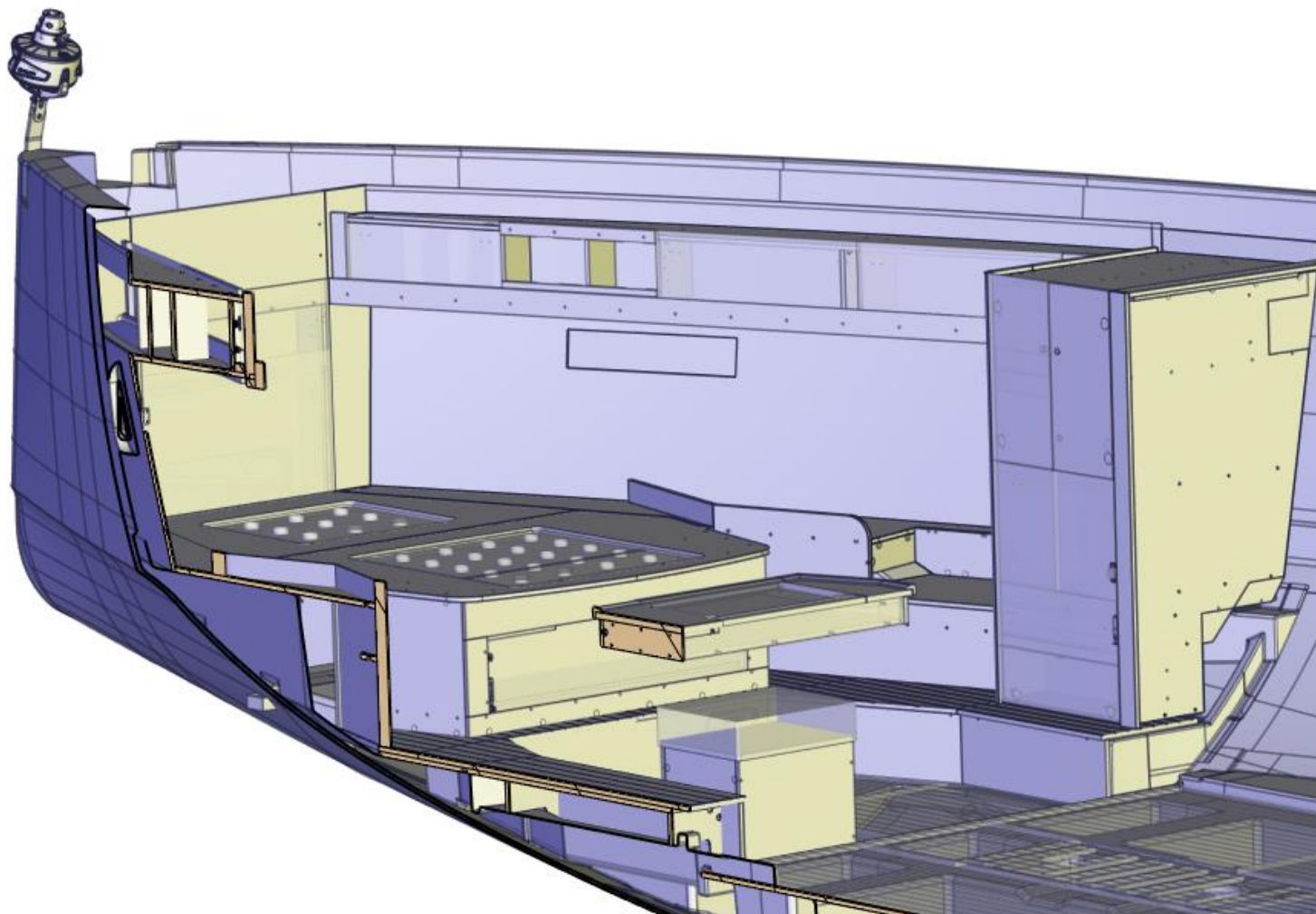

And here's the A2 cabin including  
Flagship package



## Interior

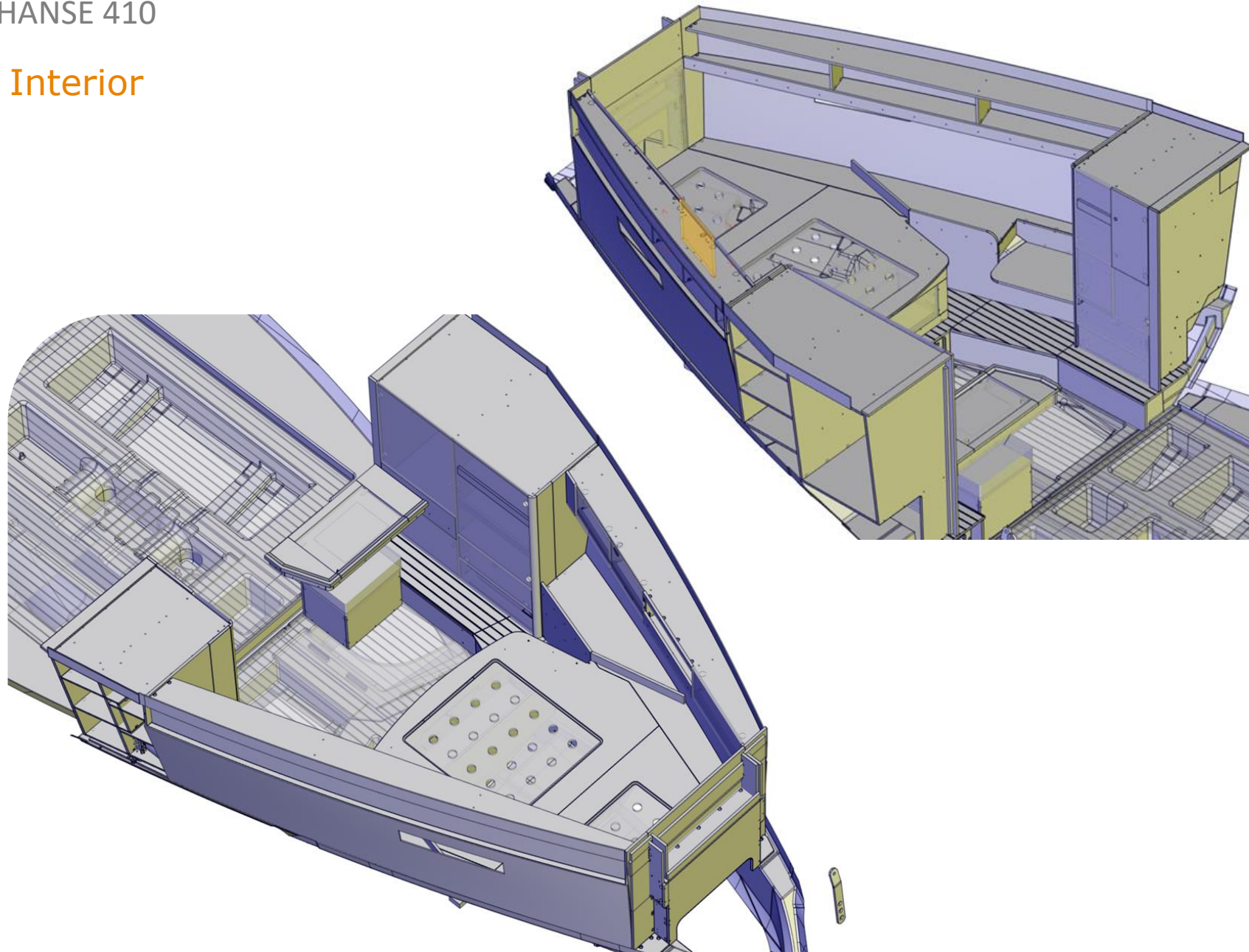

With its vanity table and an extra seat, the owner's cabin is not just a cabin but a living room.





## Interior

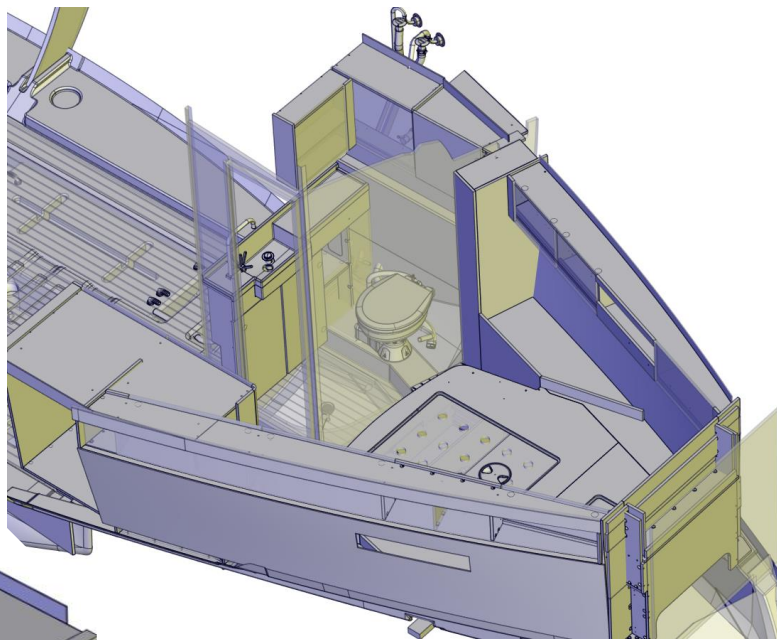
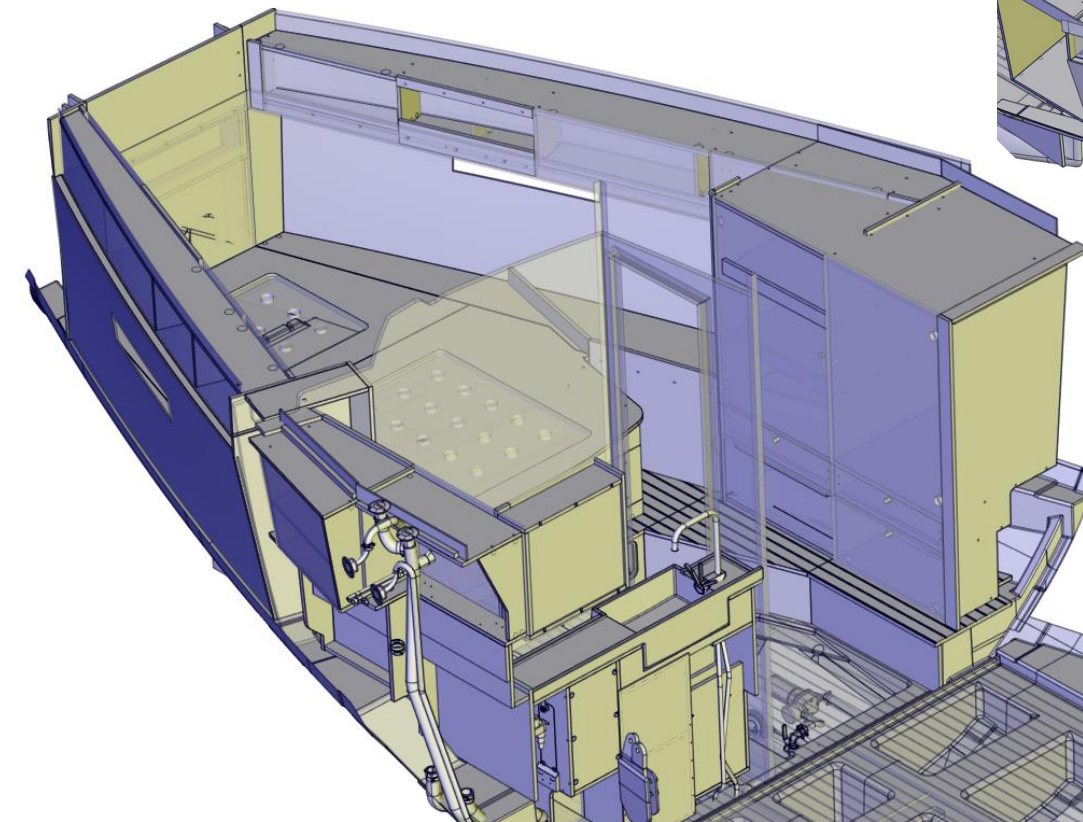

The second bathroom is a sensible and convenient addition on board.



## Interior

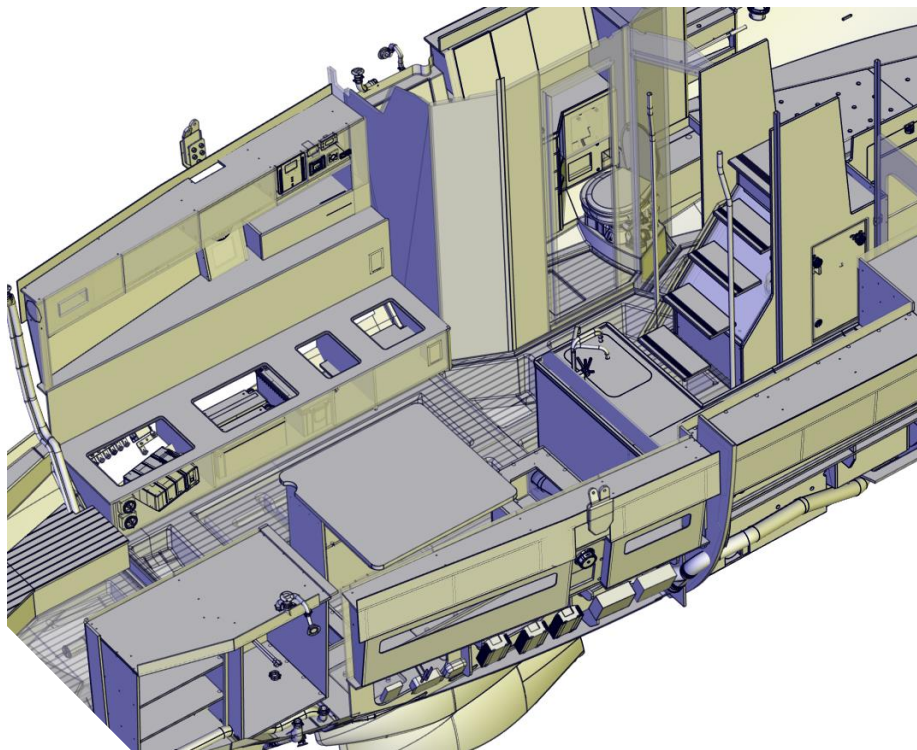
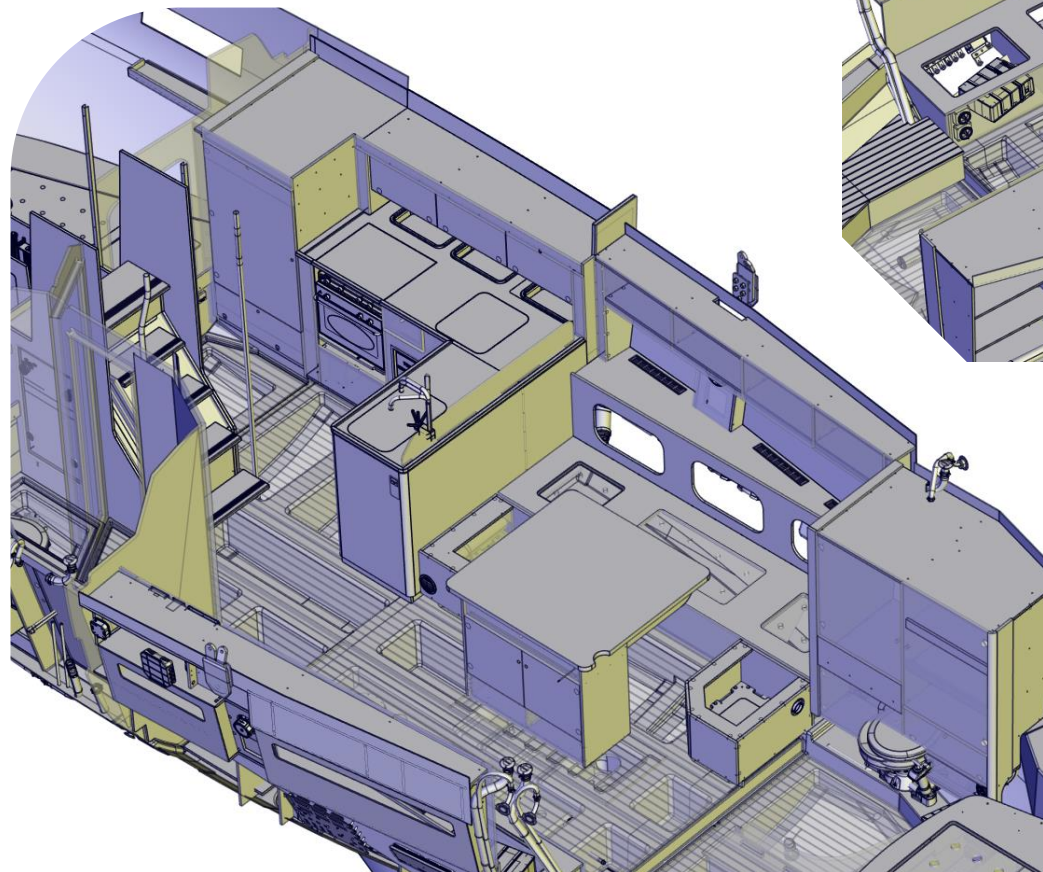

The B1 layout with a long bench offers spacious seating for family and friends.





## Interior

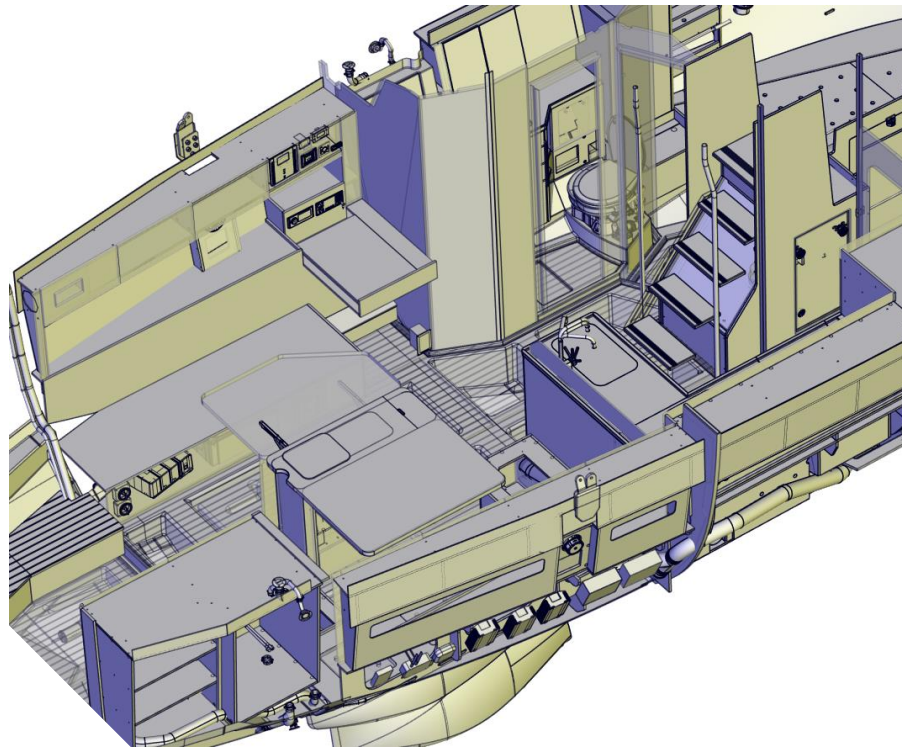
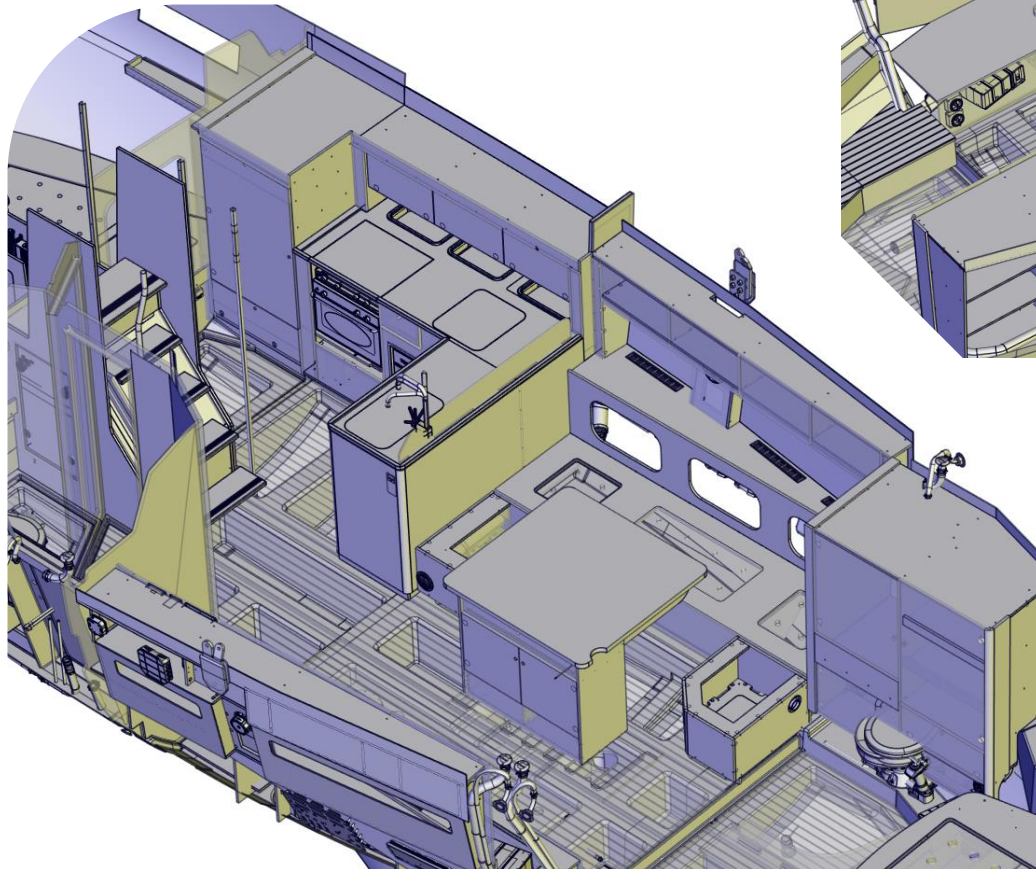

Our traditional chart table faces the cockpit for direct contact with the crew in the cockpit.



# Interior

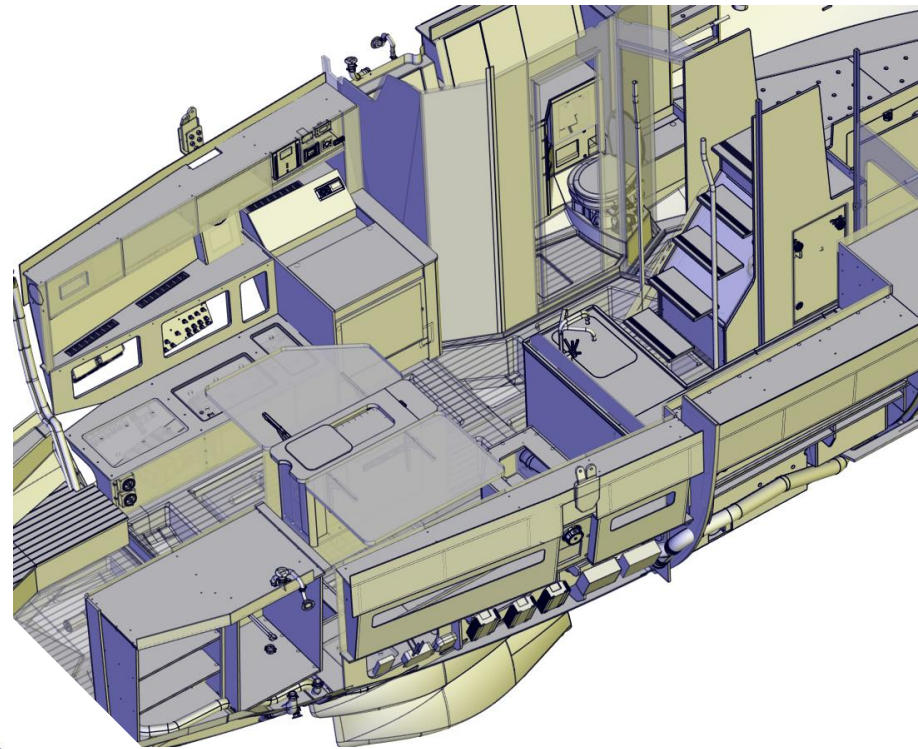
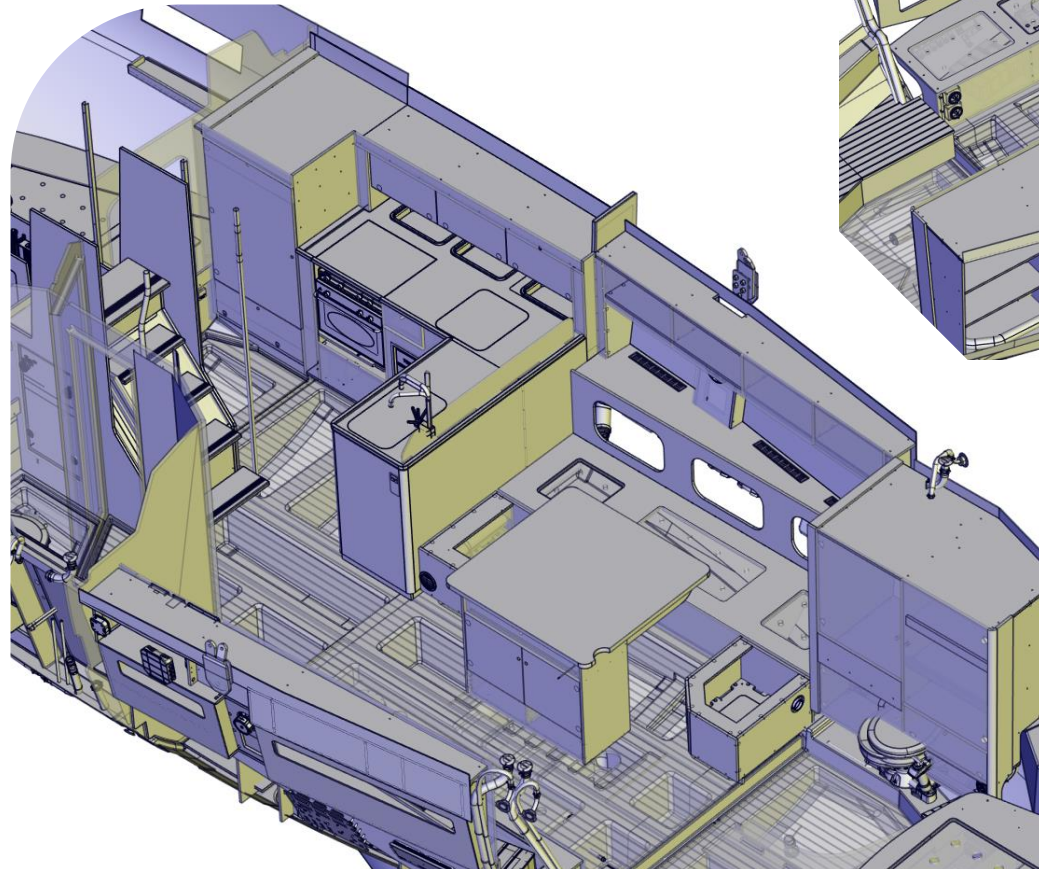

With our new multi-function unit you have the choice between storage space, a drawer fridge, a drawer freezer or a dishwasher.





Interior

Standard:

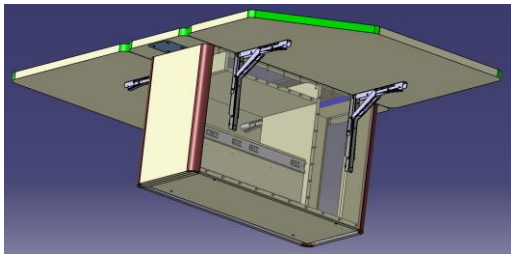
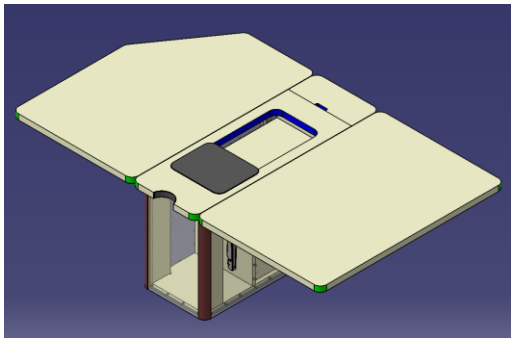
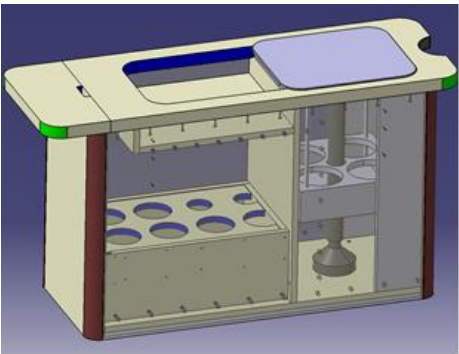
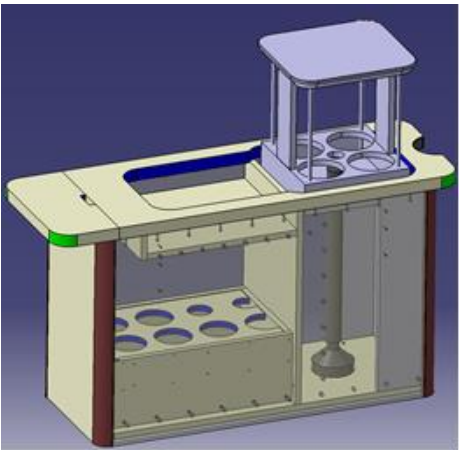
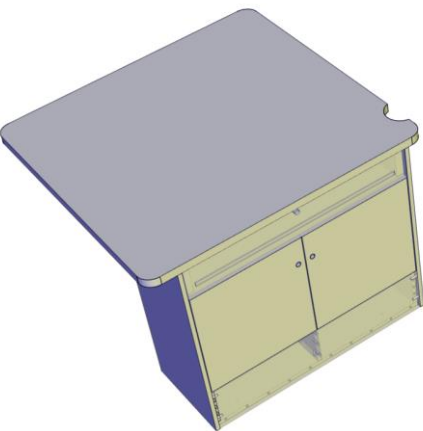

Option:

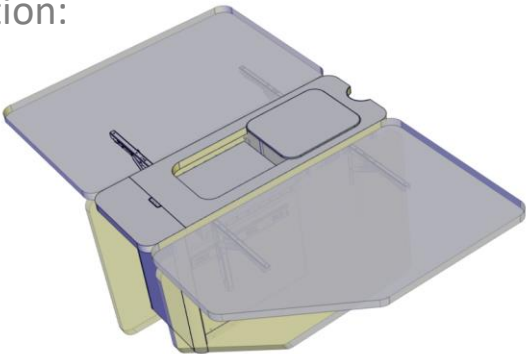

The 410's standard saloon table has a fixed table top and a lot of storage space. The upgrade version comes with two foldable tops, a flip-up bar and a convenient drawer for bottles.

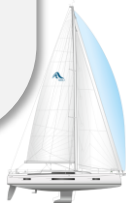

## Interior

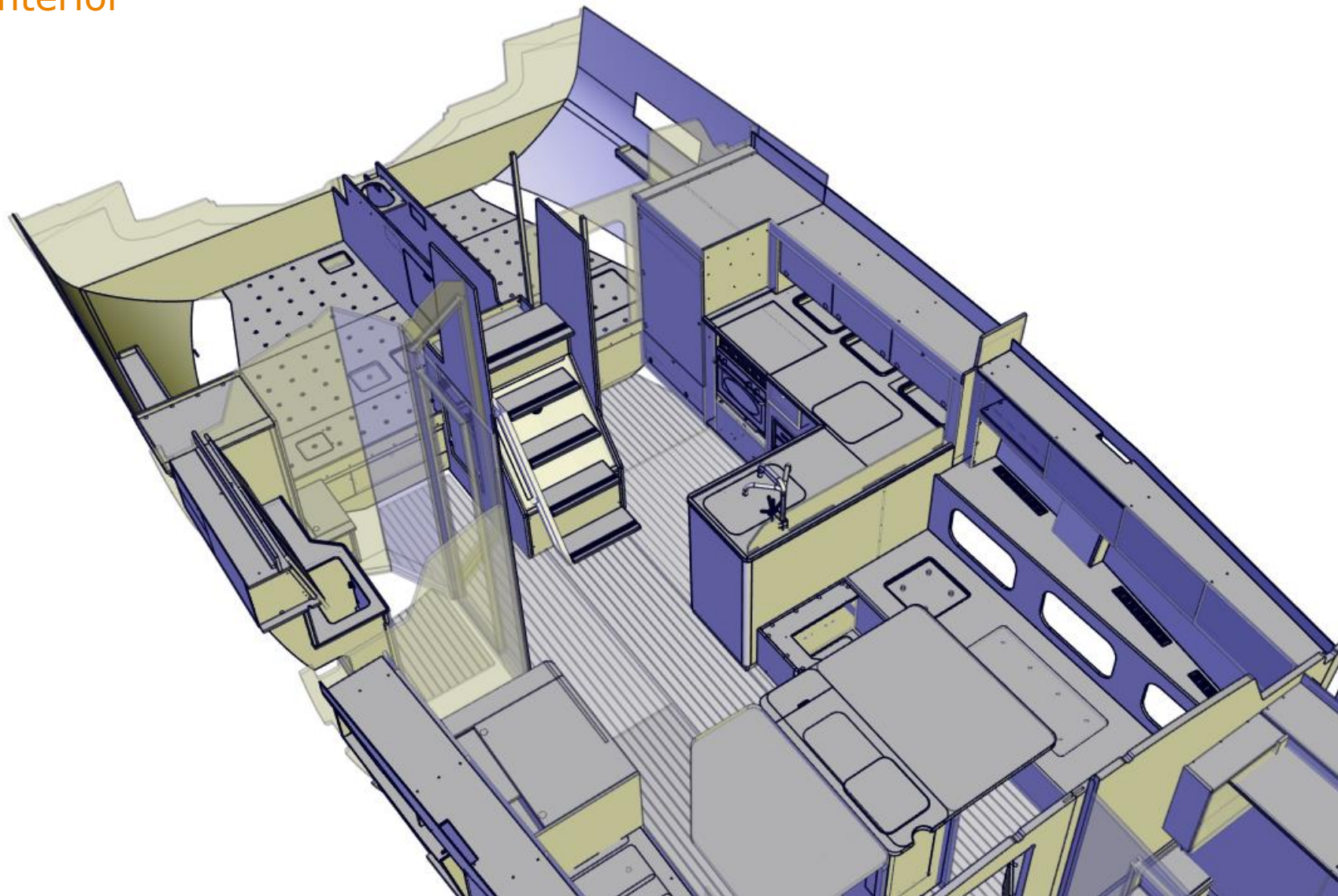

In the two-cabin version we offer an optional pantry extension, that allows several refrigerator options.





## Interior

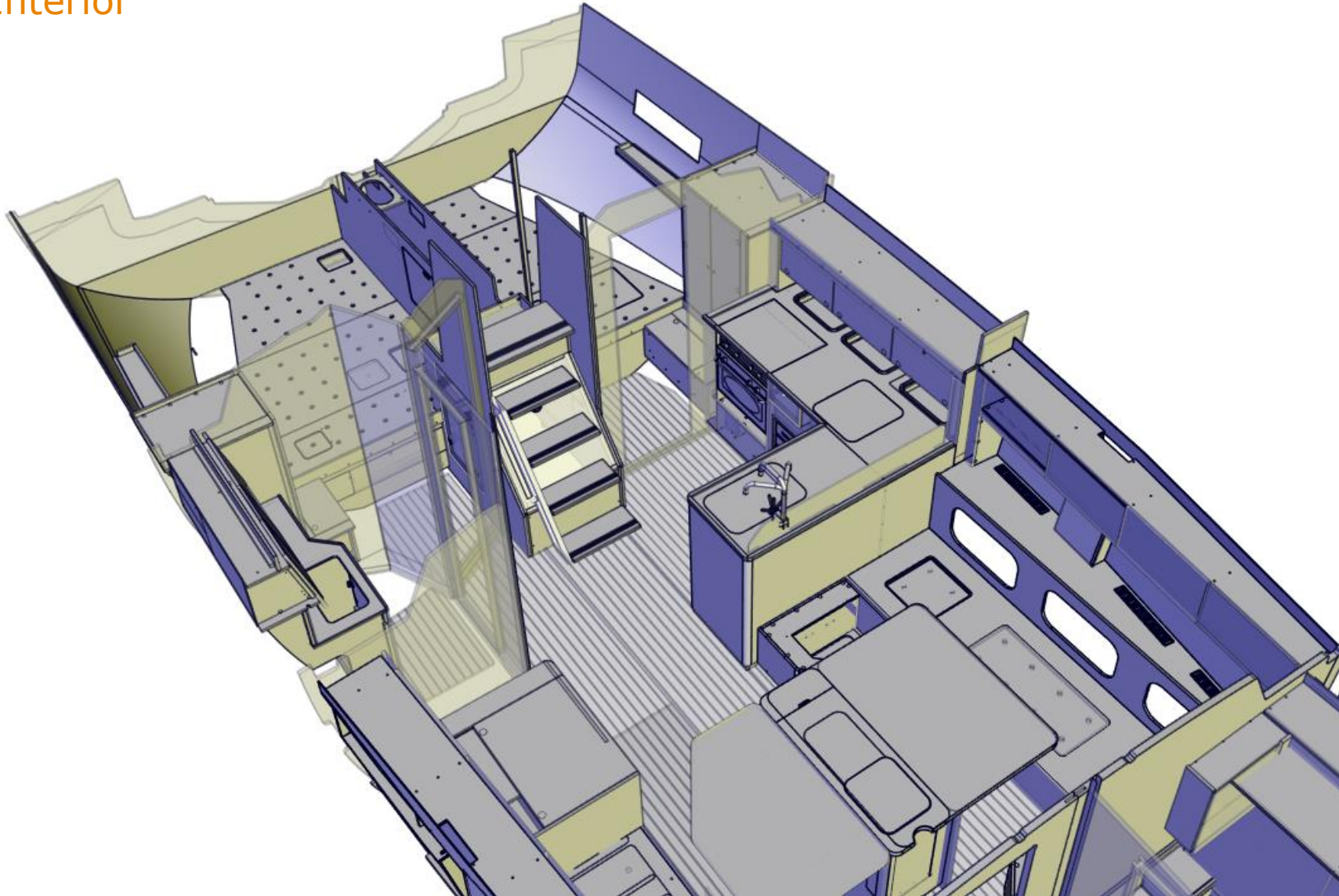

Even in the three-cabin version you don't have to miss a nice and generous galley.

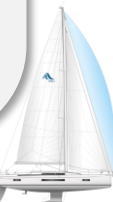







## Measurements

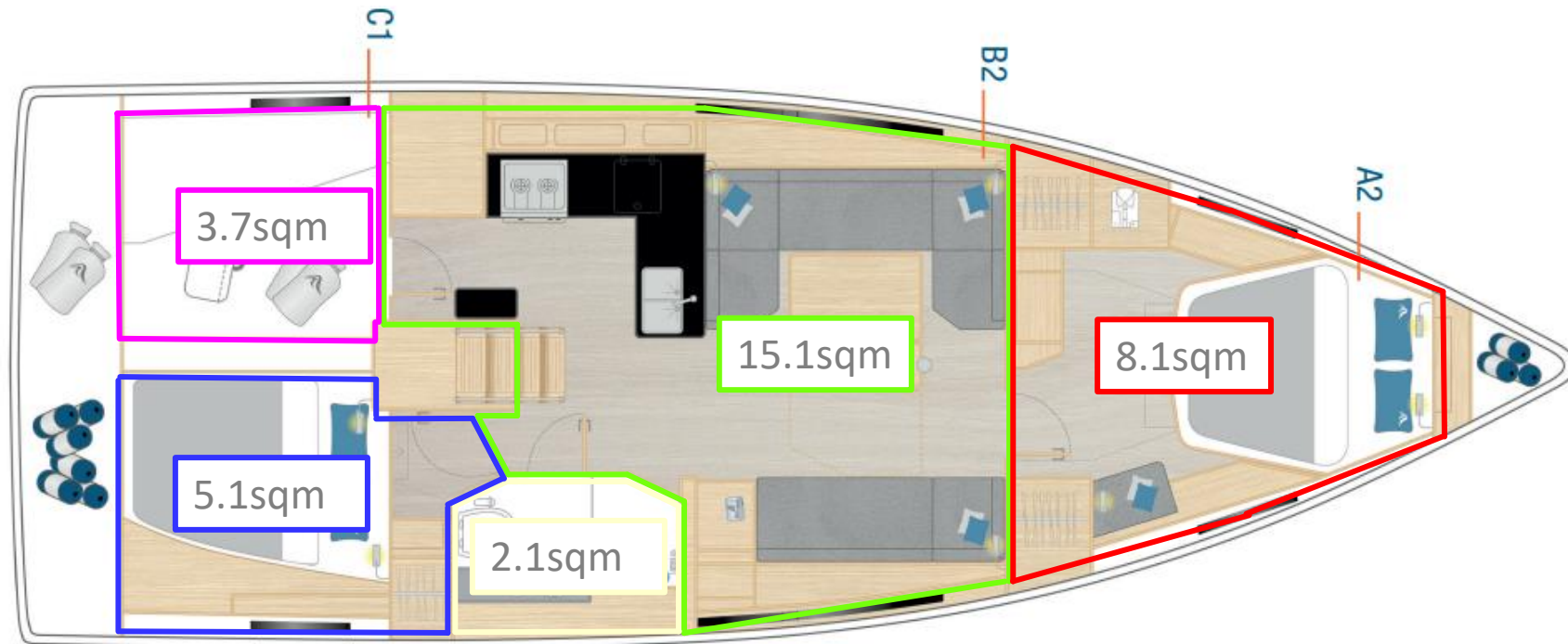

The new 410 offers unusually much space in each cabin.





Measurements

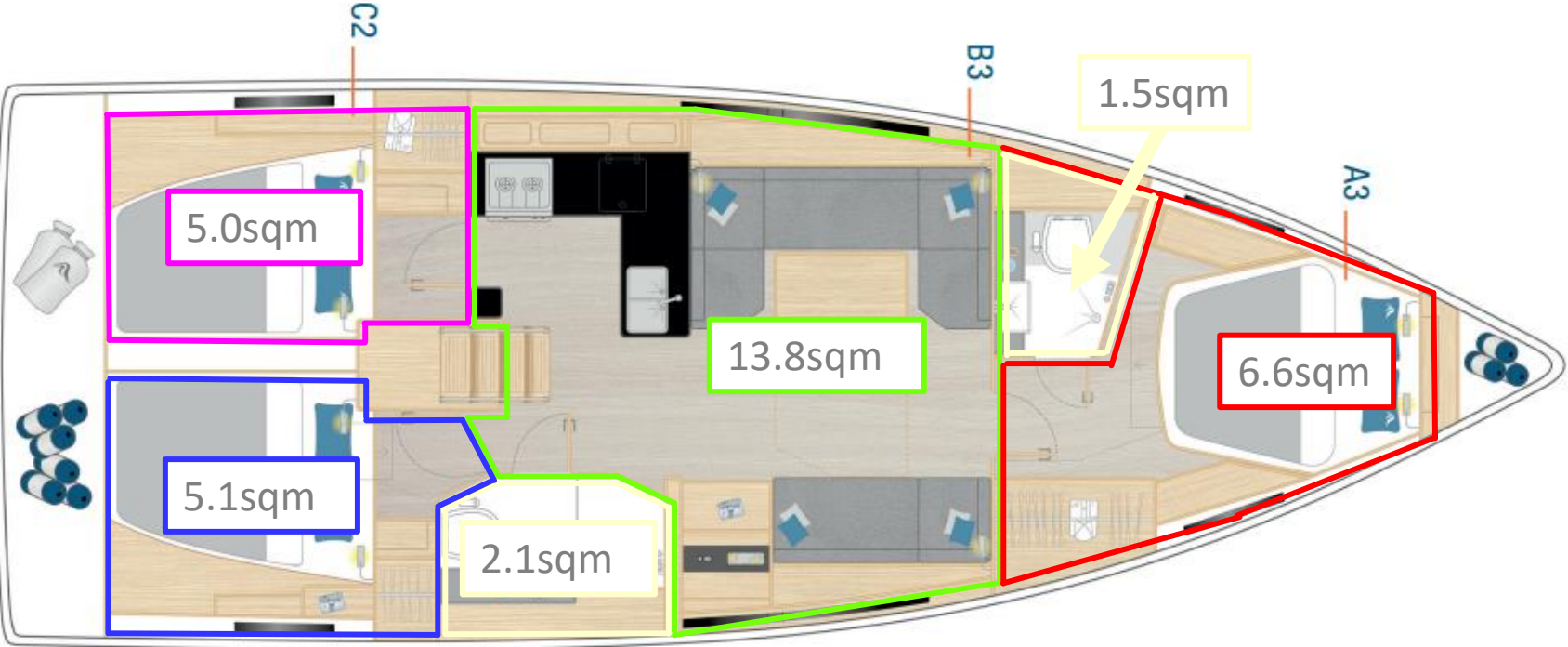

This applies to each and every layout version.

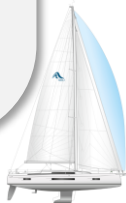

# Measurements

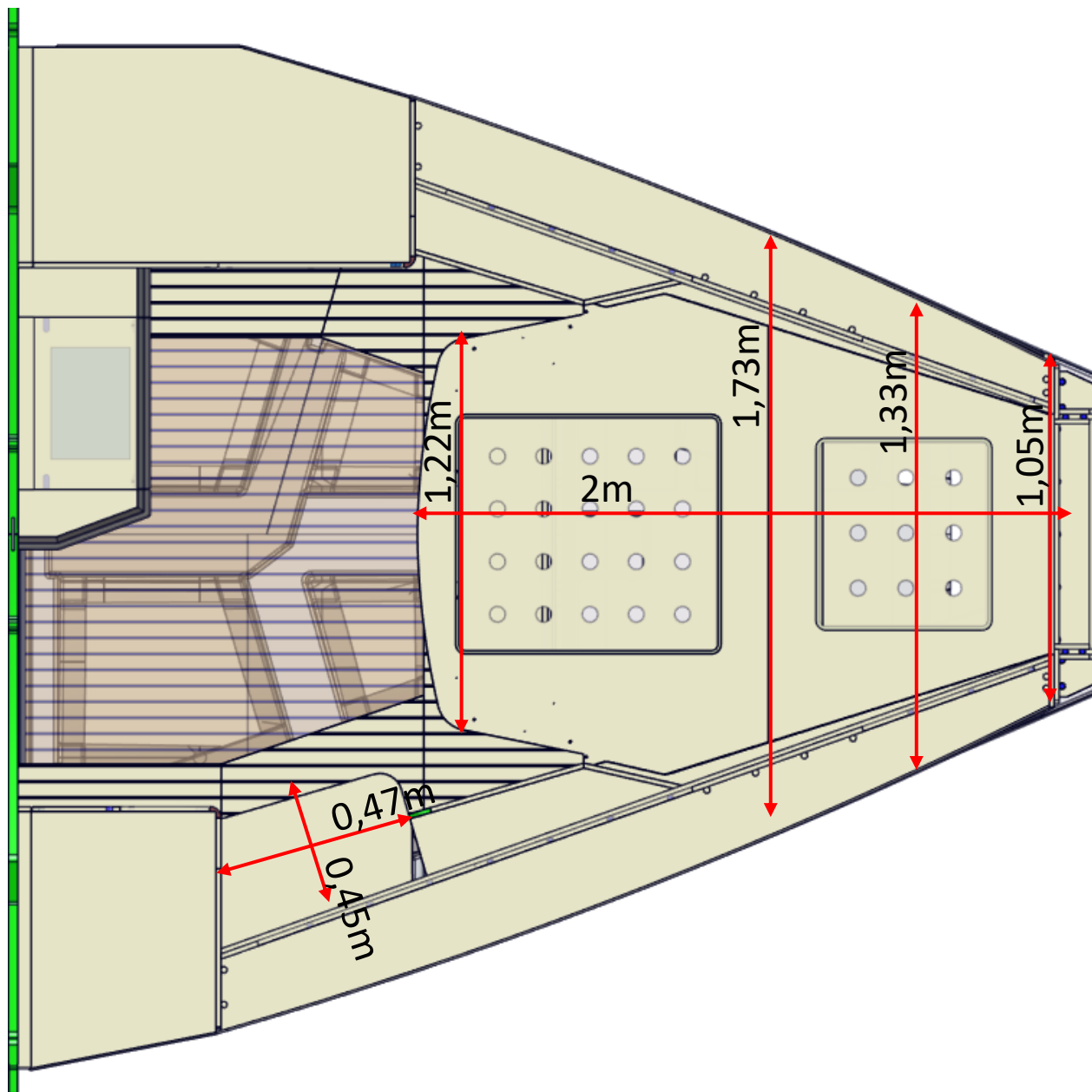

All three versions share the same wide berth.





Measurements

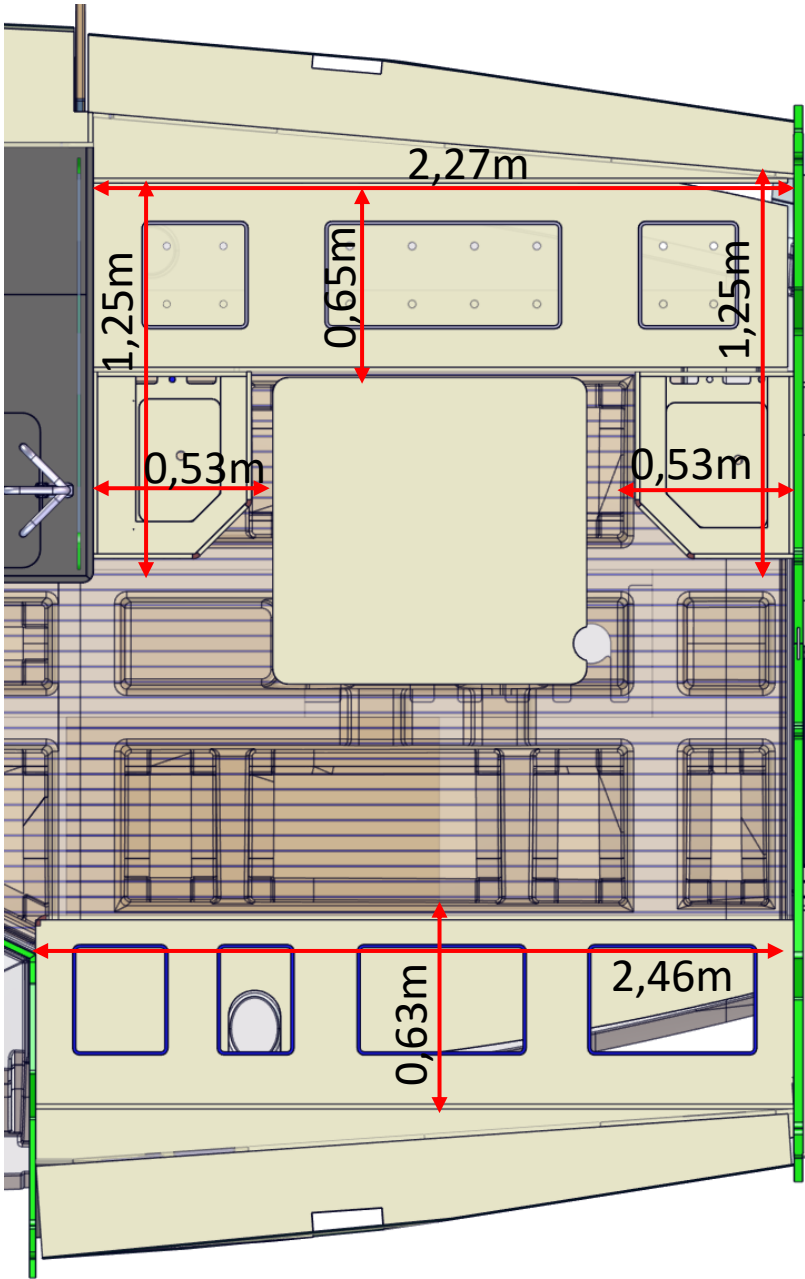

The huge seating area offers lots of space.

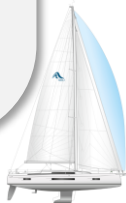

## Measurements

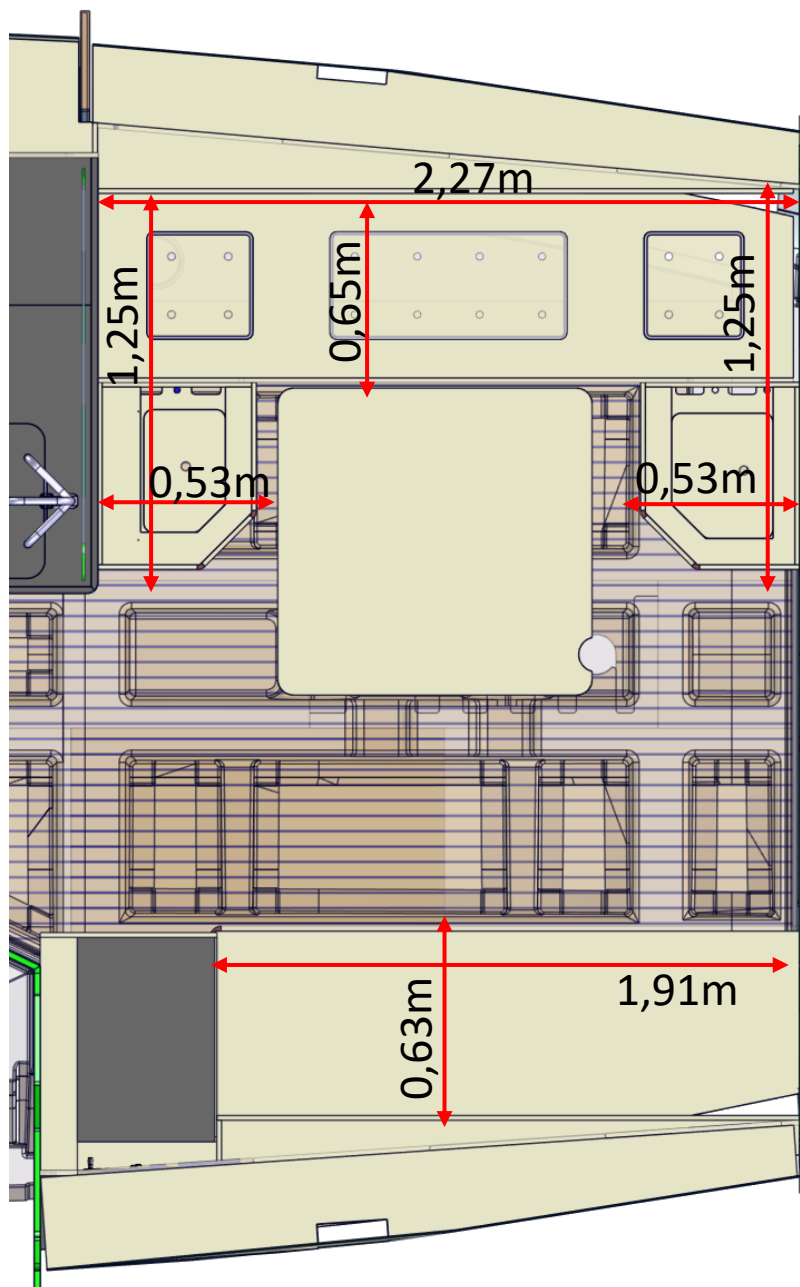

Even with the optional chart table the bench on starboard has a comfortable length of 1.9 metre.





# Measurements

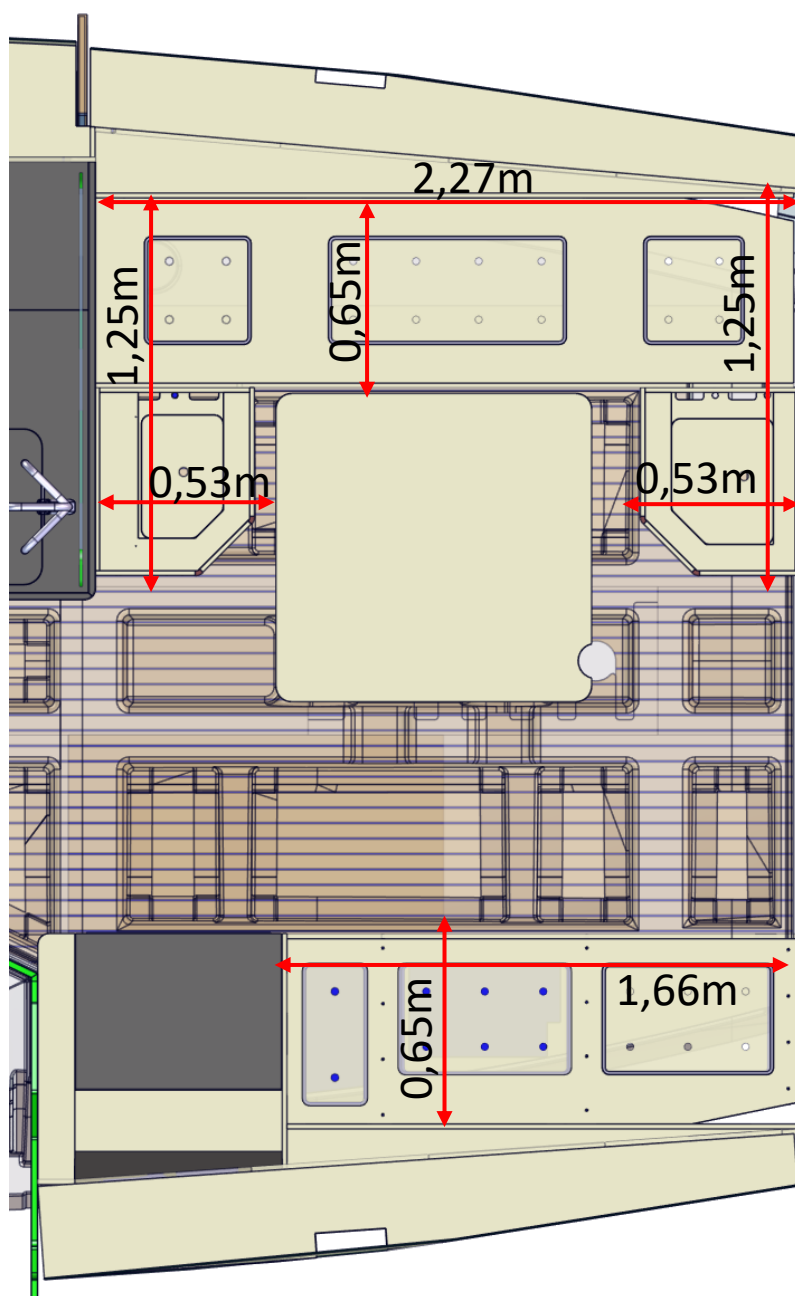

The multifunction unit creates a new dimension for the saloon.



## Measurements

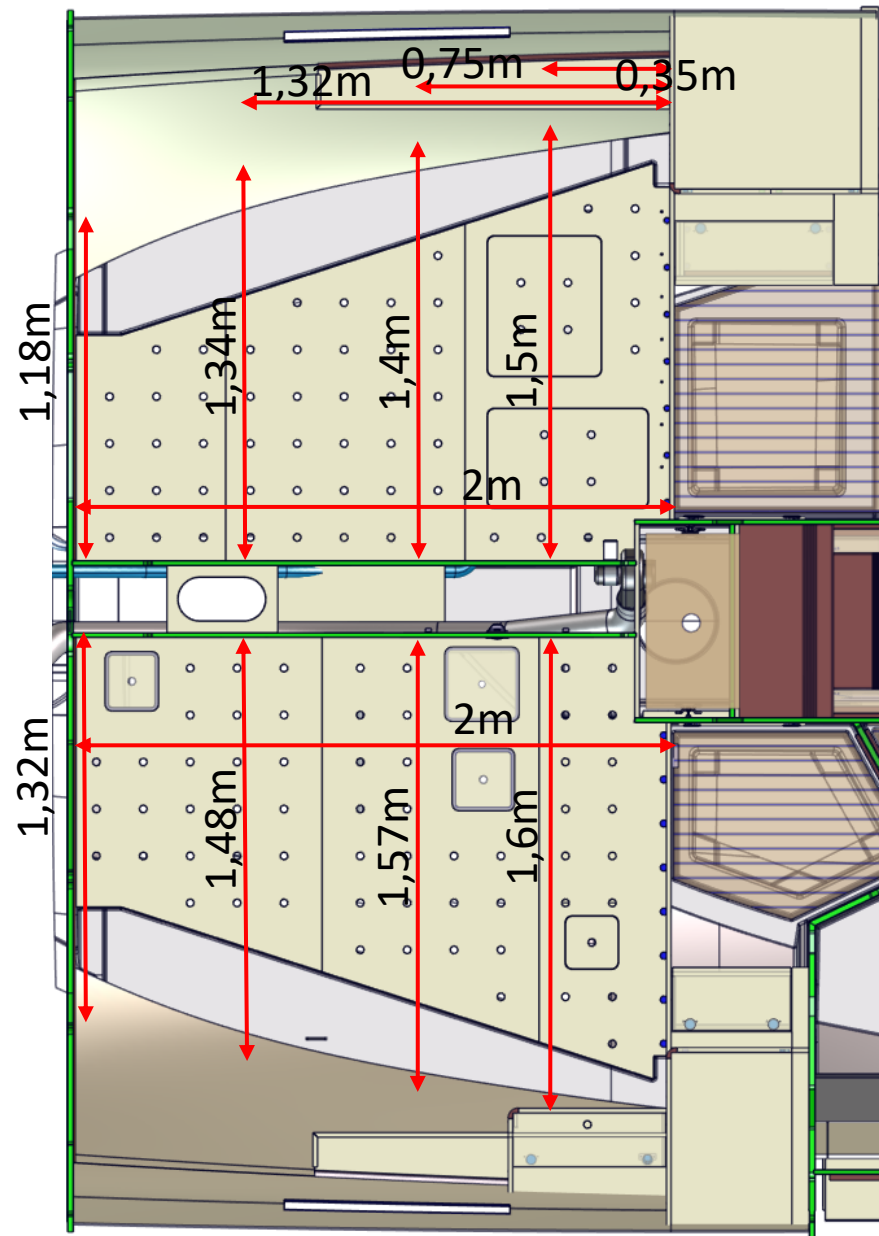

The 410's aft cabins are asymmetric, in line with the current trend, to have a wider berth on stb





Measurements

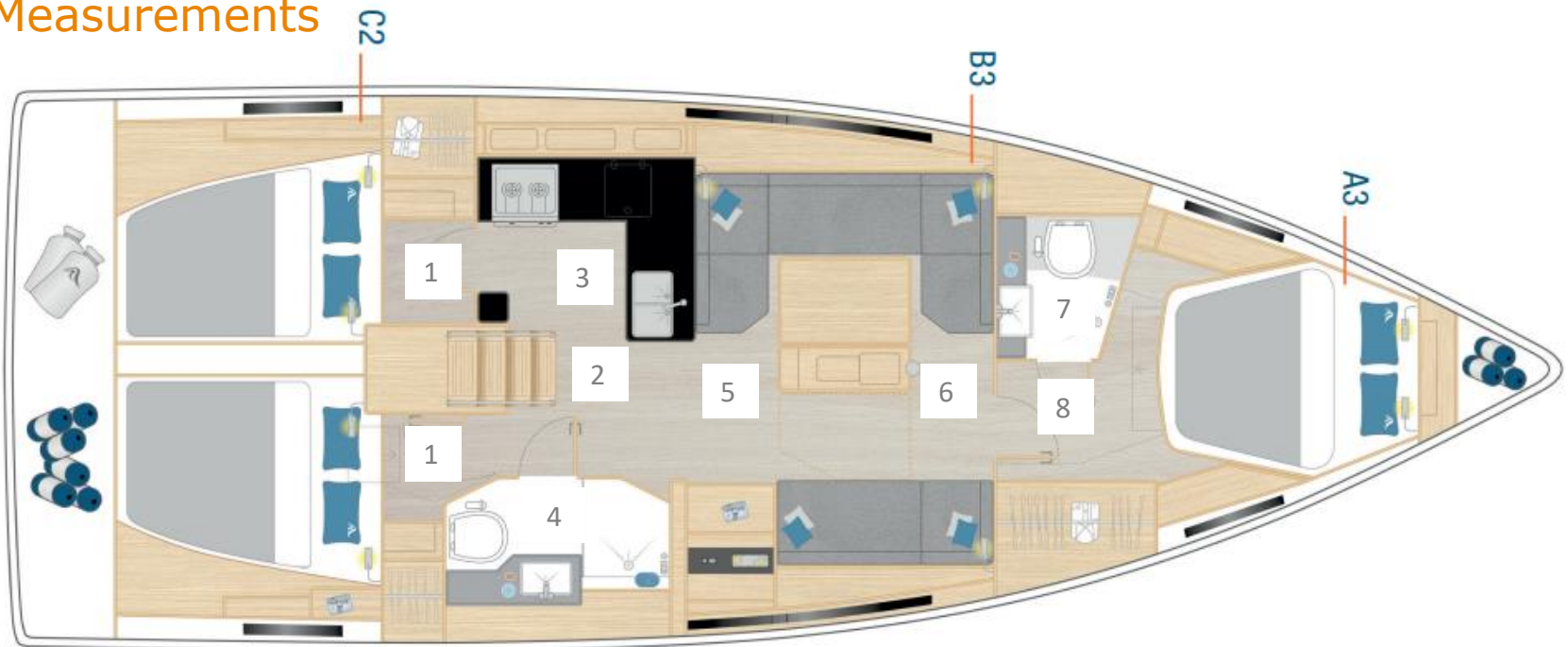

#	Area	Headroom[m]
1	Aft Cabin	2,01
2	Companienway	1,96
3	Galley	2,02
4	Bathroom	1,97
5	Saloon	1,98
6	Front Saloon	1,94
7	Fwd Bathroom	1,95
8	Mastercabin	1,96



The yachts resourceful designers have created a slim silhouette providing excellent headroom.

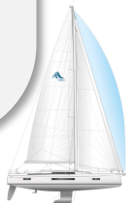







Standard specification



Technical Data	Min. Operating Condition (M <sub>LC</sub> )				
Length over all	L <sub>oa</sub>	12,55	m	41' 2"	
Length of Hull	L <sub>H</sub>	11,99	m	39' 3"	
Length on waterline	L <sub>WL</sub>	11,55	m	37' 90"	
Beam - maximum	B <sub>MAX</sub>	4,29	m	14' 1"	
Displacement	Dspl	9,68	to	21,341	lbs
Draft medium keel	T <sub>MAX</sub>	2,1	m	6' 9"	
Draft shallow keel	T <sub>SD</sub>	1,7	m	5' 6"	
Air draft (mast up)	H <sub>A</sub>	19,99	m	65`6"	
Standard Engine Diesel	approx.	29	kW	39	hp
Option Engine Diesel	approx.	41	kW	56	hp
Option Engine Electric	approx.	25	kW	25	kw
Fuel tank approx.	approx.	160	l	42	gal
Fresh water approx.	approx.	295	l	78	gal
CE Certificate		A - 10			
Design	Berret - Racoupeau				
Interior	Berret - Racoupeau				
Sail areas					
Total sail area	approx.	84	m <sup>2</sup>	904	sq ft
Main Conv.	approx.	49	m <sup>2</sup>	527	sq ft
Main Furling	approx.	46	m <sup>2</sup>	495	sq ft
Self Tacking Jib	approx.	35	m <sup>2</sup>	376	sq ft
Genoa	approx.	43	m <sup>2</sup>	462	sq ft
Crossover	approx.	74	m <sup>2</sup>	796	sq ft



These figures underline the new Hanse 410’s impressive dimensions and potential.

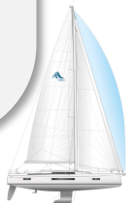



## Packages and options





## Electric propulsion

We developed a completely new electric propulsion system, which works with a well-known and proven sail drive. Based on an extremely efficient 100 Volt system, this allows an absolutely zero-emission sailing sport – if charged with green electricity.

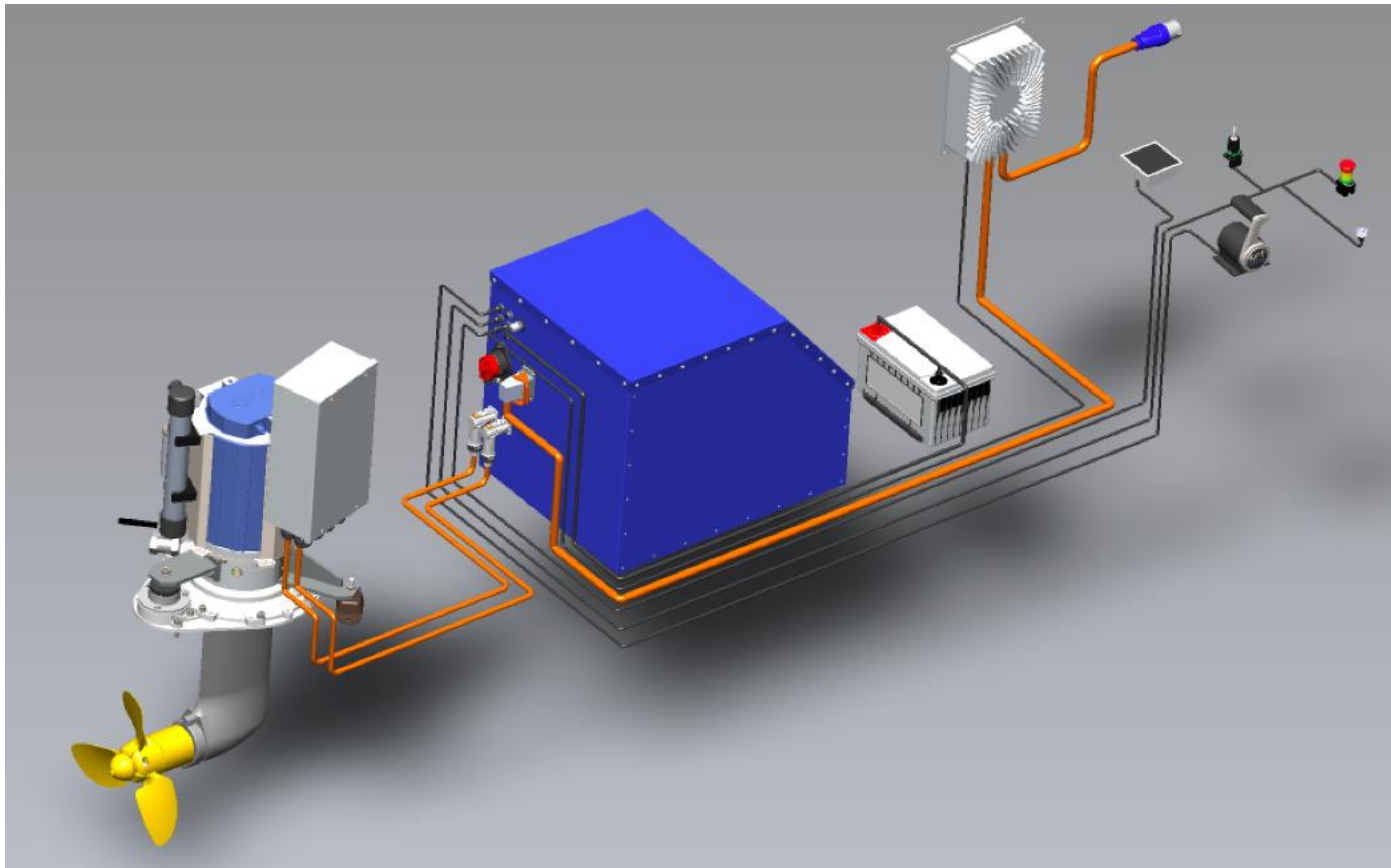

Safety on board is of utmost importance to us, so we built in an intelligent shutdown that reduces the power in case of increased battery temperature to prevent a collapse, but that's not enough for us, so together with the battery manufacturer we have designed a compact stainless-steel container for the batteries. This way they are perfectly protected.

This option is only available with XW2001.

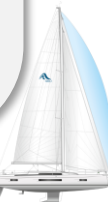

Fuel cell

Proven in a wide range of stationary and mobile industrial applications, it's now also available for a superior travel experience on the Hanse 410 with a high energy demand. With a maximum power of 125 W and a maximum charging capacity of 250 Ah per day, the new EFOY Pro 2800 delivers powerful and environmentally friendly electricity.

The EFOY charges the service battery fully automatically and maintenance-free. It switches on when the battery needs charging and switches off again when the battery is fully charged, you only need to change the fuel cartridge when it is empty.

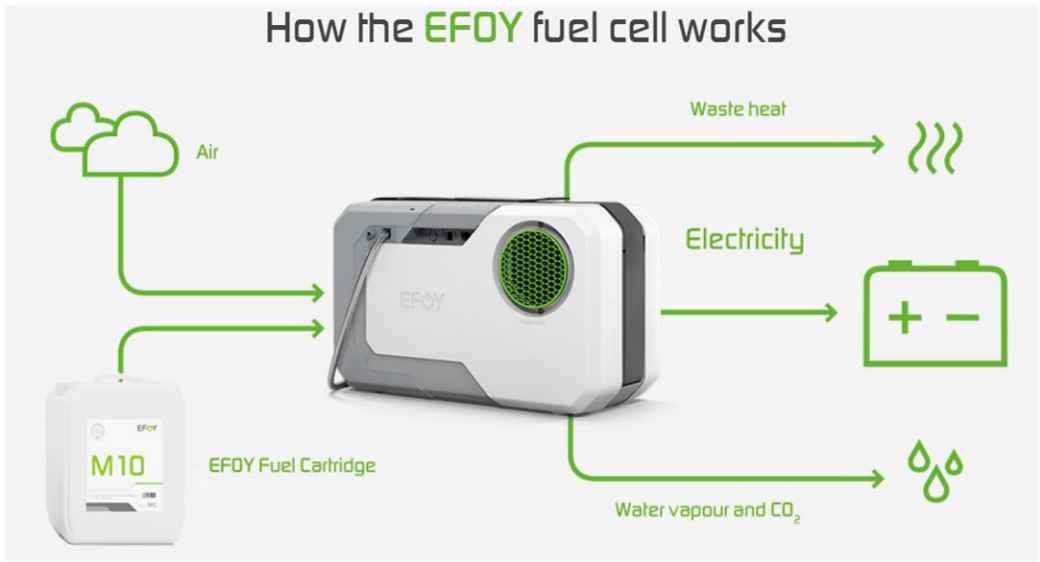

Please use Wlan Router, to get better usage. Updates are much easier with WLAN



We have been using this fuel cell in our Hanse 385 company yacht for nearly two years now without any problems. With its intuitive operation, it is an easy-to-use system.





## Solar moduls

The Hanse 410 offers solar modules with a total of 335 W power as an option.

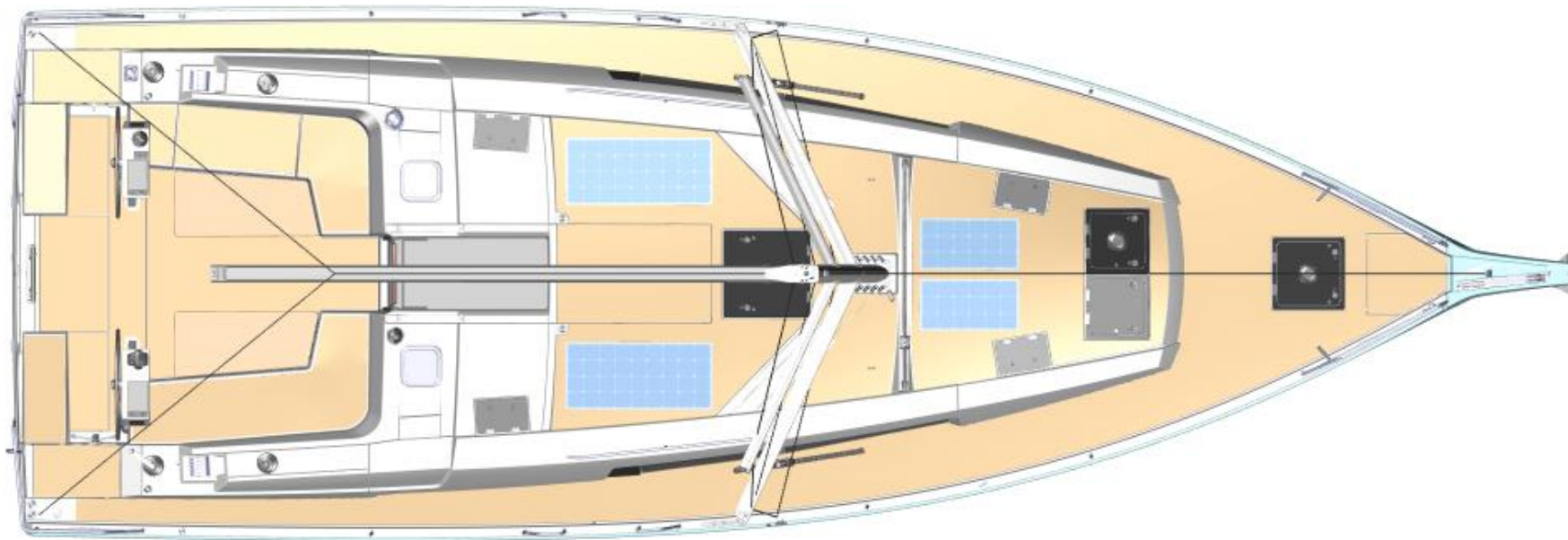

335 W more than suffice for everyday needs such as running the refrigerator (approx. 240 Wh/day).



Battery options

There are three different options for service batteries

XH1000    1x 160Ah AGM  
(Standard)

XH1001    2x 160Ah AGM



XH1005    2x 200Ah LiFePO4

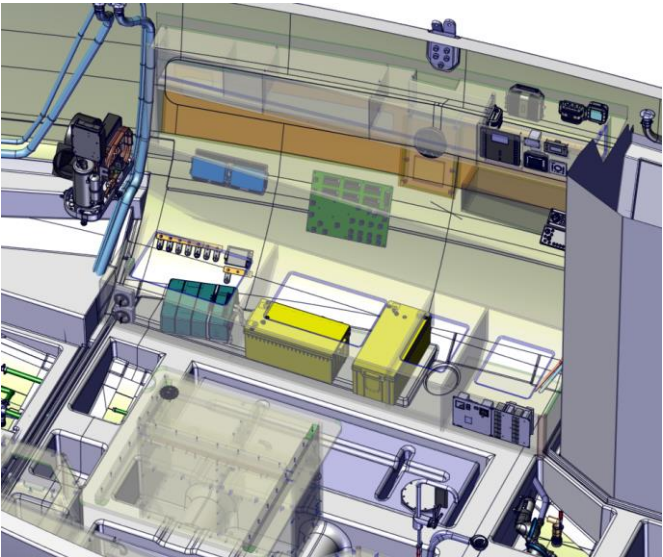
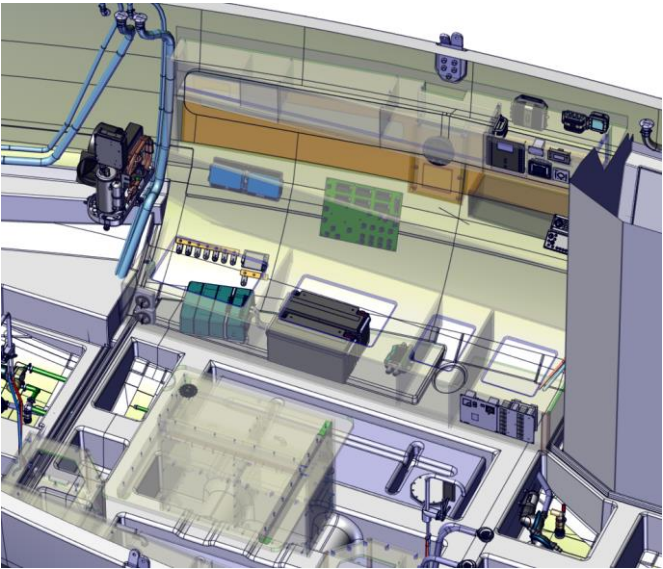

The LiFos 200 battery has an integrated BMS and a main switch. When switched off, the battery loses only 2 % of its charge within six months – a great advantage also in winter storage.

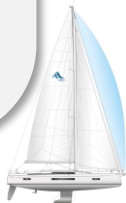



## Smart Connection Package

Smart living on board made easy with this package:

### XF4655 Interior camera

With these cameras, you can see what's happening on board from the comfort of your own home. And when you are on board, simply store the wireless cameras in the cupboard to ensure that your privacy cannot be disturbed.



### XK5031 WLAN router incl. booster antenna

Yacht Router Mini s5 will provide the ability to establish two vessel networks (e.g. owner, guests) as WIFI and cable version. Each vessel network can be simultaneously connected to either the same or to different internet sources. The Yacht Router Mini's dual card slot allows to use two SIM cards from one or two providers.

For WIFI connection over long distances, WIFI Booster s5 is the device of choice. This add-on module is part of this package. WIFI Booster is a waterproof, power-over-ethernet device that can be installed directly on the mast. With the high-gain outdoor antenna, expect an internet connection of up to 10 NM range, in good conditions even more.



Internet on board is almost a must, and with this package you are connected to the world wide web even in the bay in front of the marina.

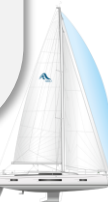

## Synthetic teak and teak options

Synthetic teak is available in these colours :

- |                       |                       |                          |
|-----------------------|-----------------------|--------------------------|
| 1. Classic Teak Black | 4. Grinded Teak Black | 7. Blue Water Teak Black |
| 2. Classic Teak Grey  | 5. Grinded Teak Grey  | 8. Blue Water Teak White |
| 3. Classic Teak White | 6. Grinded Teak White |                          |



The alternative is real teak:



We changed the colours to lighter versions to reduce the temperature on deck.

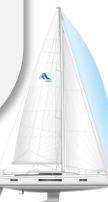



Synthetic teak and teak options

1	XC1300	Real teak on side deck
	XC1301	Synthetic teak on side deck (colour selection)
2	XC1310	Real teak on coach roof
	XC1311	Synthetic teak on coach roof (colour selection)
3	XC1325	Real teak on cockpit bottom
	XC1326	Synthetic teak on cockpit bottom
4	XC1333	Real teak on helmsman seats
	XC1334	Synthetic teak on helmsman seats
5	XC1340	Real teak on cockpit benches
	XC1341	Synthetic teak on cockpit benches
6	XC1350	Real teak on bathing platform
	XC1351	Synthetic teak on bathing platform

Part of the Cruising Package or Upgrade

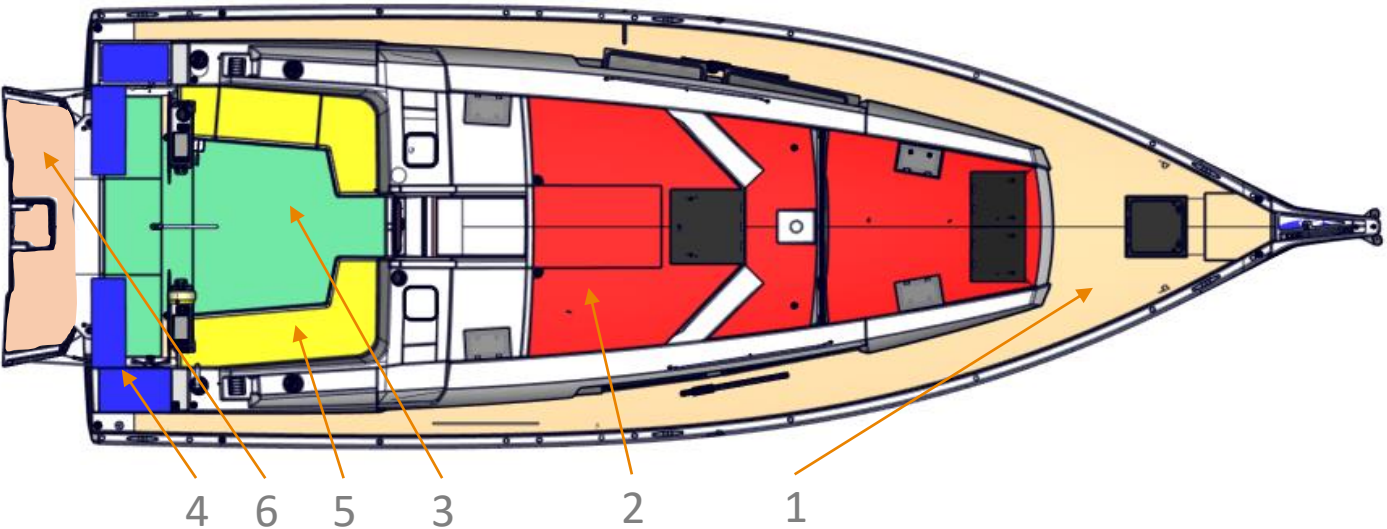

Not only for reasons of sustainability, synthetic teak now is the norm while real teak has become the upgrade.

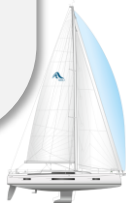

## BBQ in the Cockpit

XC3100 Wetbar with BBQ in cockpit

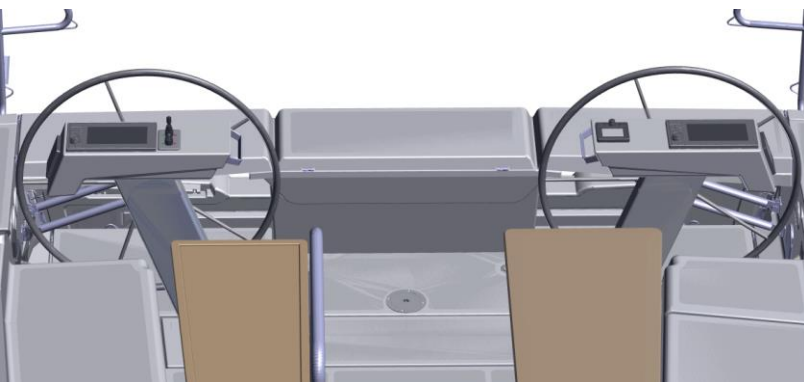
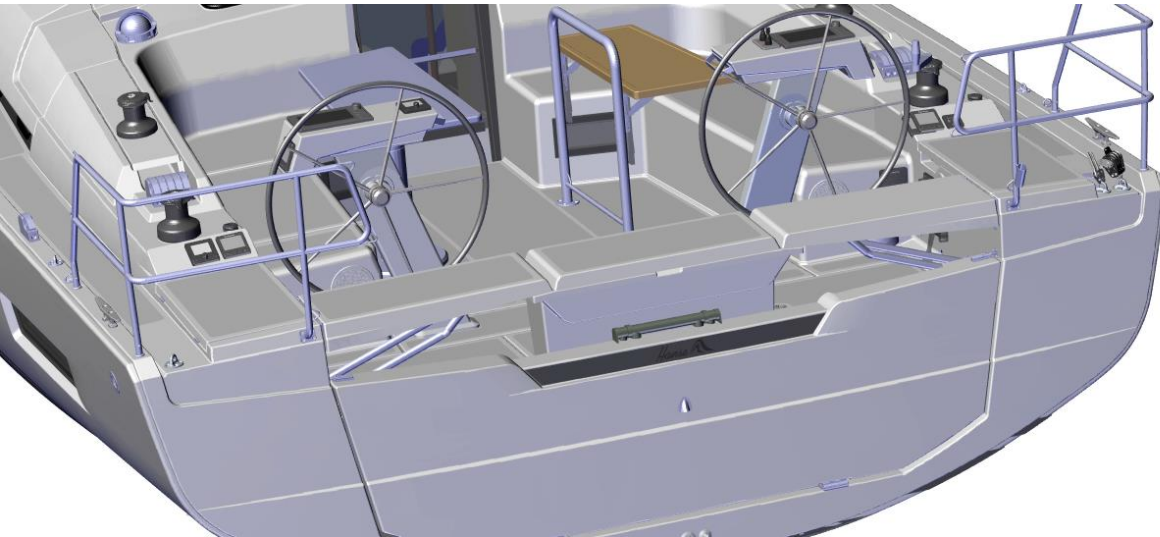

With this nice feature you can also create a more forward-looking seating area in the cockpit.





## Cockpit tables

XC3003 Cockpit table with stowage and fridge

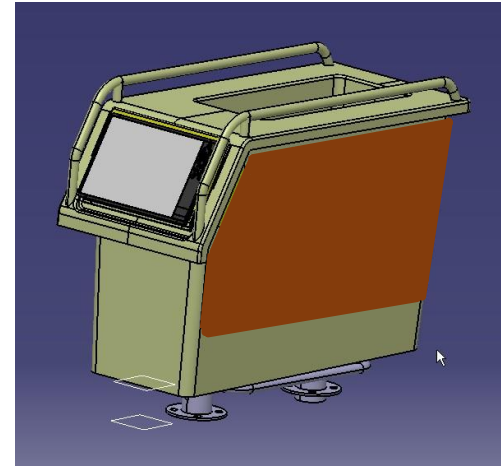

XC3004 2 cockpit tables with teak top, electrically lowerable into sunbed incl. upholstery

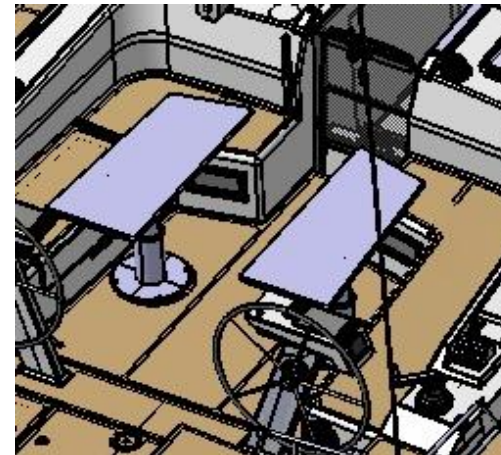

Standard:  
2 cockpit tables, stainless steel  
with folding teak tops

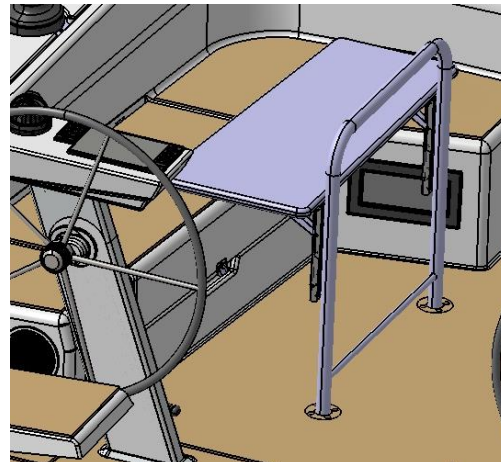

All three versions create a completely different cockpit atmosphere



Rig and sails

Sail areas:  
Conventional main  
Furling main  
Self tacking jib  
Genoa  
Cross over  
Gennaker

Rig measurements:  
Air draft  
I  
J  
P  
E

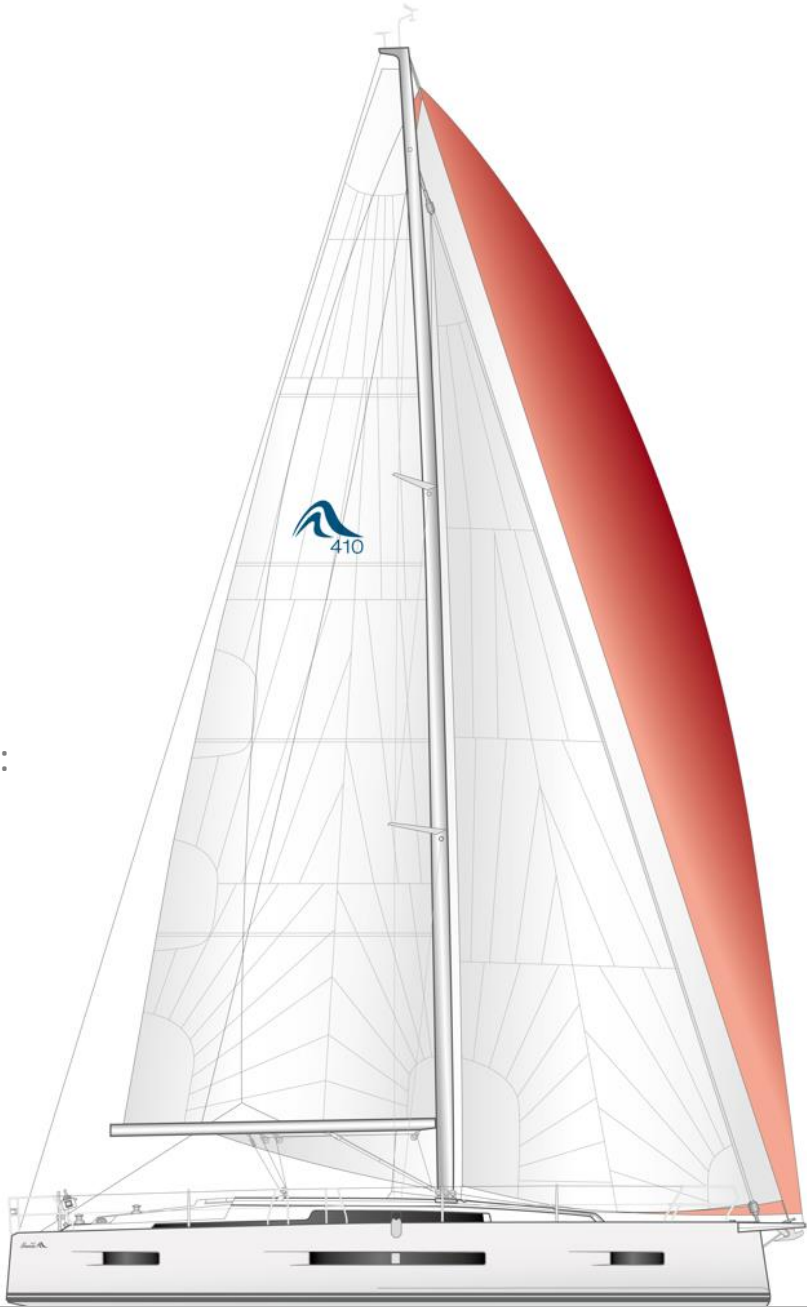

49 sqm  
46 sqm  
35 sqm  
43 sqm

19.99 m  
16.60 m  
4.80 m  
16.55 m  
4.95 m



High and sporty: our new 410, naturally, features the typical Hanse rig.





Sail quality

Standard is our Elvstrøm Dacron  
Layout: Cross Cut

1st upgrade: Elvstrøm Blue Water Dacron Cross Cut  
Layout: Cross Cut

2nd upgrade: Elvstrøm SPS  
Sustainable Performance Sail  
Layout: Triradial





Sail type: Conventional Main Sail  
Material: Elvstrøm SPS  
Sustainable Performance Sail  
Layout: Triradial  
Features: 5 horizontal battens,  
2 reefs, Trim stripes

Sail type: Selftacking furling jib  
Material: Elvstrøm  
SPS Sustainable Performance Sail  
Layout: Triradial  
Features: 4 short battens,  
Trim stripes, Silver UV

Sustainable Performance Sail (SPS); Mit Elvstrøm Sails haben Sie die Möglichkeit, etwas zu bewirken, indem Sie ein Segeltuch wählen, das überwiegend aus recycelten Materialien hergestellt wird. Das hochwertige Laminatsegel ist weich und sehr leicht zu handhaben.

Sustainable Performance Sail (SPS): With Elvstrøm Sails, you have an option of making a difference by choosing a sail cloth made from mainly recycled materials. The high-end laminate sail is soft and easy to handle.



Our newly available Sustainable Performance Sails are the first sails made of recycled material – for the sake of the environment and for maximum sailing performance.

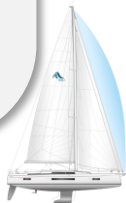



## Navigation package

### XW2000 Raymarine Navigation Package

XF2200 2 Raymarine i70s multifunction displays in cockpit, incl. transducer (wind/depth/speed/temperature)

XF3000 Raymarine VHF Ray63 in saloon, incl. wireless remote handset (only with XK5000)

XF4010 Raymarine AXIOM PRO 9 S chart plotter with HybridTouch multifunction display

XF5000 Raymarine Evolution Autopilot with p70s display and wireless remote control

XK5000 VHF preparation with antenna and splitter for FM and AIS

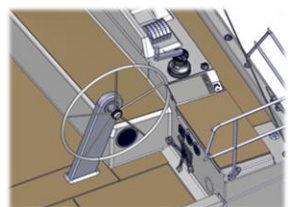

### XW2001 Upgrade - 2 Raymarine AXIOM PRO 9 S chart plotter at helm station (1 each side)

XF2000 2 instrument pods (1 per helm station)

XF4030 2 Raymarine AXIOM PRO 9 S chart plotter with HybridTouch multifunction display, 1 per helm station

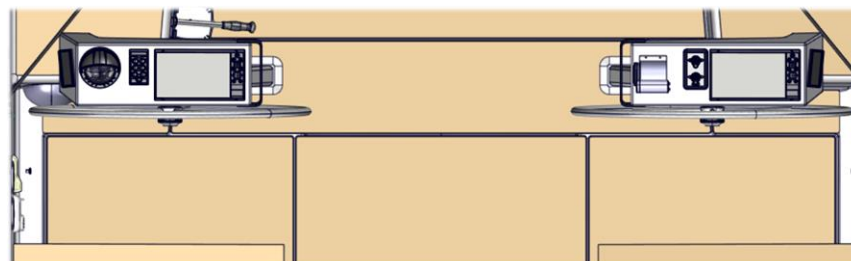

Our upgrade package brings all the options usually only to be found on far more expensive boats.





## Propulsion

XG1001 Engine (Diesel, approx. 39 hp) - saildrive, 2-blade folding propeller



XG1103 Engine (Diesel, approx. 57 hp) - saildrive, 3-blade folding propeller



XG1500 electric propulsion (approx. 25kW / 18,4kWh battery) - saildrive, 3-blade folding propeller

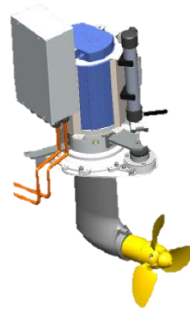

XG1510 electric propulsion (approx. 25kW / 36,7kWh battery) - saildrive, 3-blade folding propeller



XG3101 Bow thruster, 12 V, retractable, incl. battery

XG3201 Stern thruster, 12 V, retractable, incl. battery



Let your customers choose from a wide range of options, depending on their individual needs and requirements.

Electric drive require plotter pods (XW2001) for the throttles.

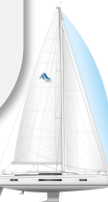

## Entertainment package

XW7000 Entertainment package

XH2090 Wireless charging in saloon

XK1000 FUSION MS-RA70N Multimedia radio with bluetooth - for saloon and cockpit

XK2000 2x 2 speakers in saloon and cockpit

XK3070 FUSION MS-NRX remote control in cockpit



XW7001 Upgrade - premium radio

XK1001 FUSION APOLLO MS-RA770 multimedia radio with Wi-Fi and touchscreen - for saloon and cockpit

XK3071 FUSION MS-ERX400 remote control in cockpit

XK5030 FUSION wireless link - remote control via mobile devices



Perfect entertainment for every customer's needs.

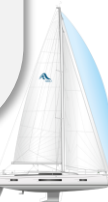



New DC panel

Our new DC panel provides excellent monitoring and direct feedback. It can also be used with an app for mobile devices. This enables a person on board to connect their mobile phone to the panel and, for example, check the tank volume and battery capacity or make adjustments.

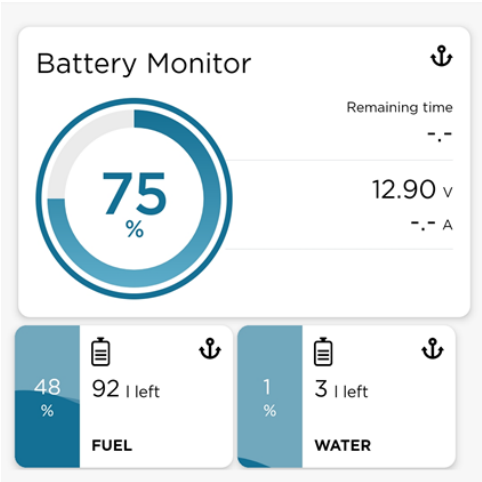

The switches provide a good feedback. We moved the fuses from the back of the panel behind the bench – well sorted and easy to replace.

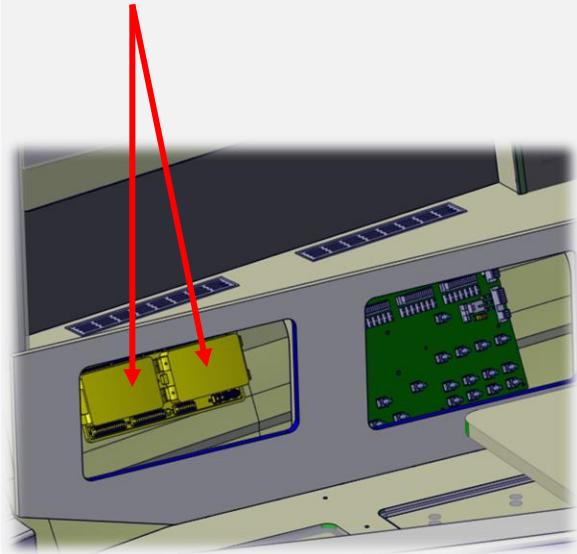

## Generator

With the generator, not only the air condition can be run independent of shore power. Even more, it can be used as a range extender for the electric drive. It delivers with its variable speed up to 5KVA while providing only as much power as needed and thus keeping unavoidable noise within limits.

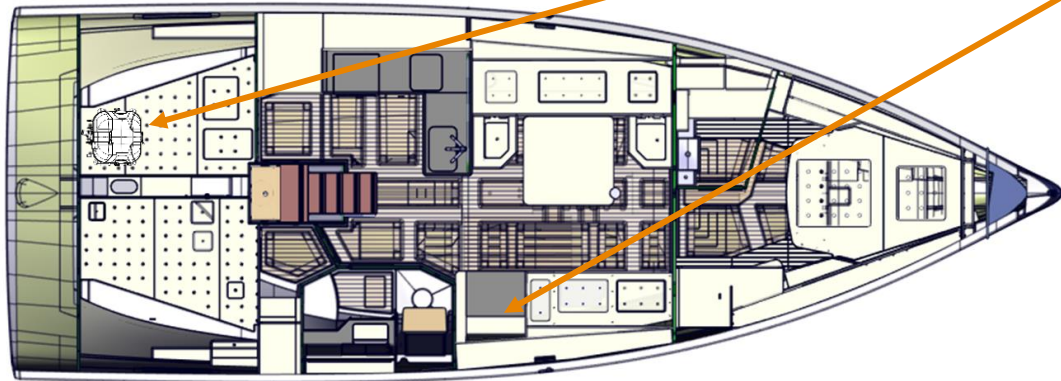

For the US market, we use the Whisper Power M-GV 4 Piccolo, as we have to comply with different emission standards there.



We fought hard to realise your wish made during the last workshop. And we succeeded in placing a generator on this 41-footer. The limits of the boat's dimensions, however, allow for this option with the C1 layout only.

The Aircon needs in max. 3,2kW, so we are save with this generators





















## Flagship package

This package includes:  
XL7225 Additional sideboard for the galley at companionway

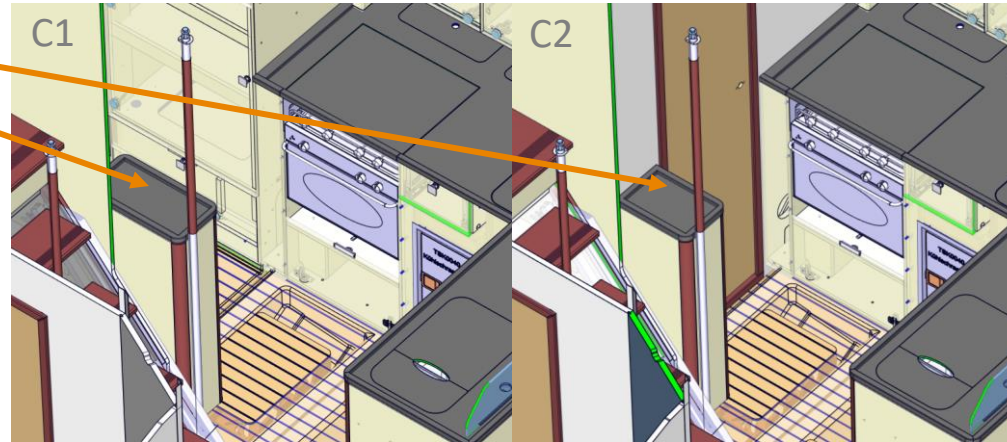

Std

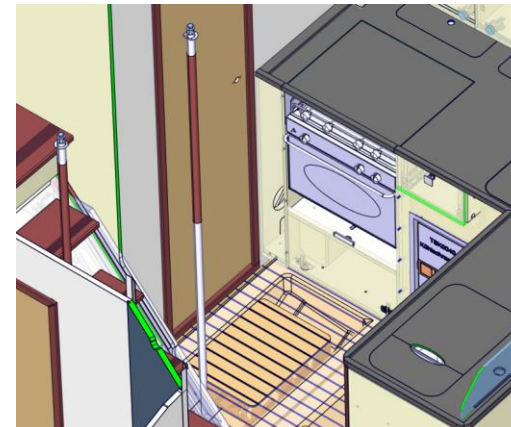

Storage space can't be enough in your boat.



Flagship package

This package includes:  
XL7235 Headboards for aft cabins:

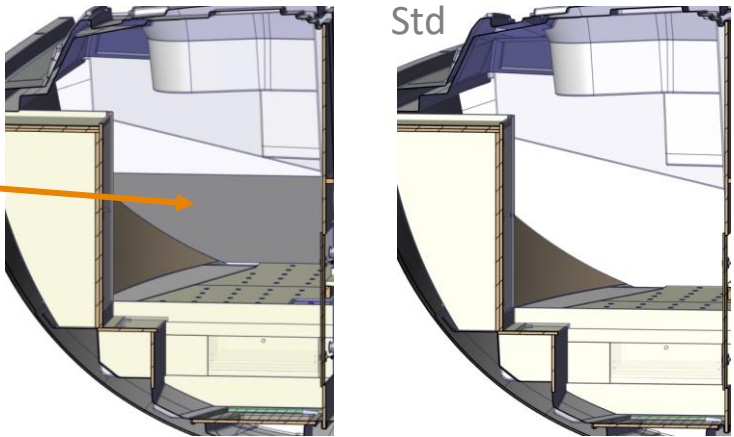

XL7300 Upper locker in owner's cabin instead of shelves



For this model, too, we thought long and hard about how we could upgrade a luxury product. And we have succeeded with that.

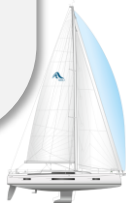



Flagship package

This package includes:  
XL7305 Night tables in owner's cabin and stb aft cabin

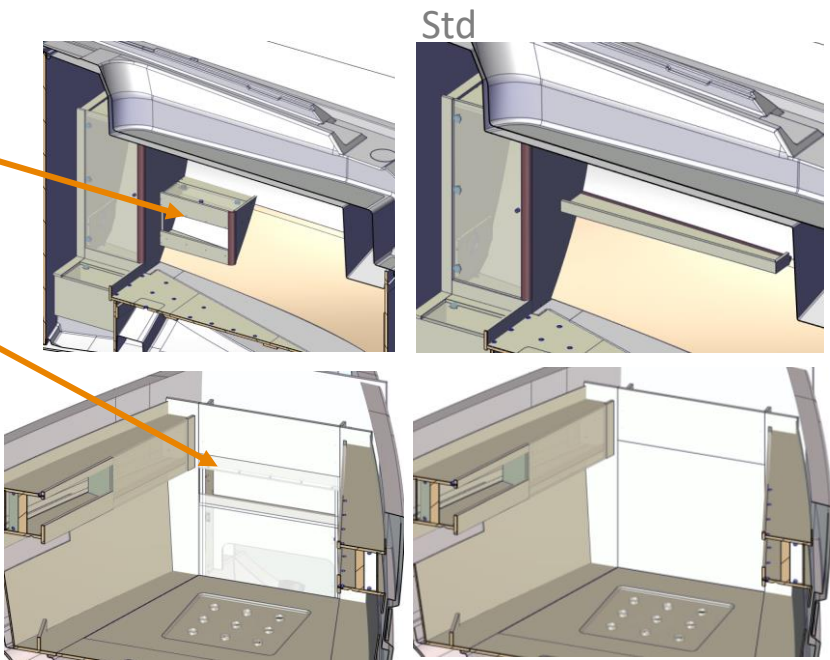

XL7410 Leather-covered handrails



Many fine and precious details transform a series yacht into a real flagship.

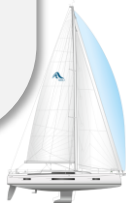

Flagship package

This package includes:  
XL9002 Reading lights at main bulkhead

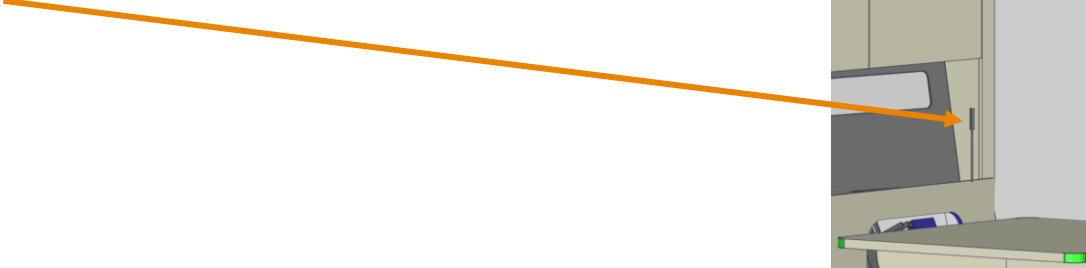

Std

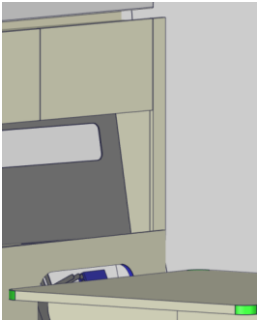

XN2055 Luxury upholstery with multi-function backrests



Std



The moulded upholstery and the noble material mix of the upgrade are a serious gain in comfort and a feast for the eyes.





## Galley options

XH5101 Additional fridge in galley (only layout C1)

XH5150 Microwave in galley

Standard double stainless-steel sink with mixing tap

Standard 3-burner gas stove with oven

Standard 12 V fridge approx. 135 l

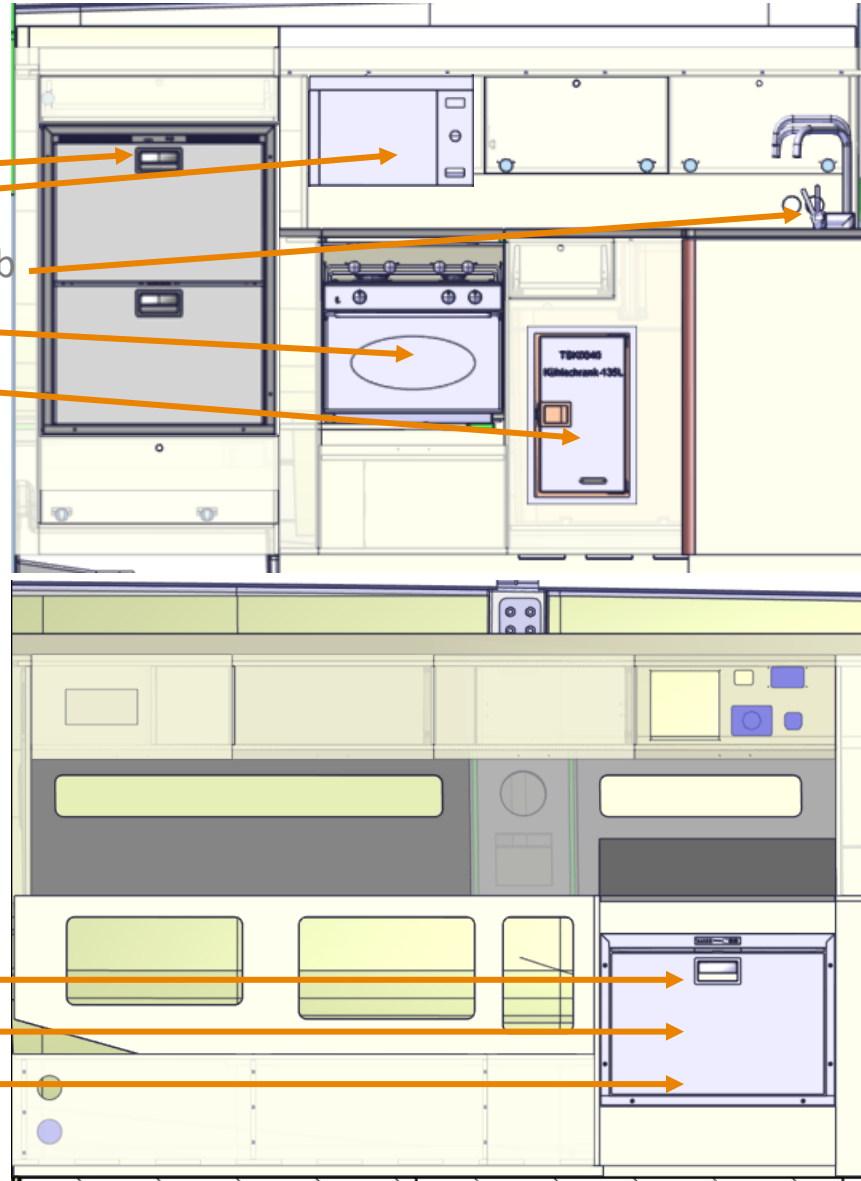

Only in Layout B3:

XH5100 Additional fridge in multi-function unit

XH5120 Additional freezer in multi-function unit

XH5210 Dishwasher in multi-function unit



The Hanse 410 offers all kitchen options one could wish for on a boat of this size.

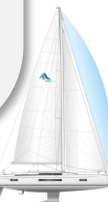

Interior Colours

Interior wood: Marine optimised real wood veneer from ALPI

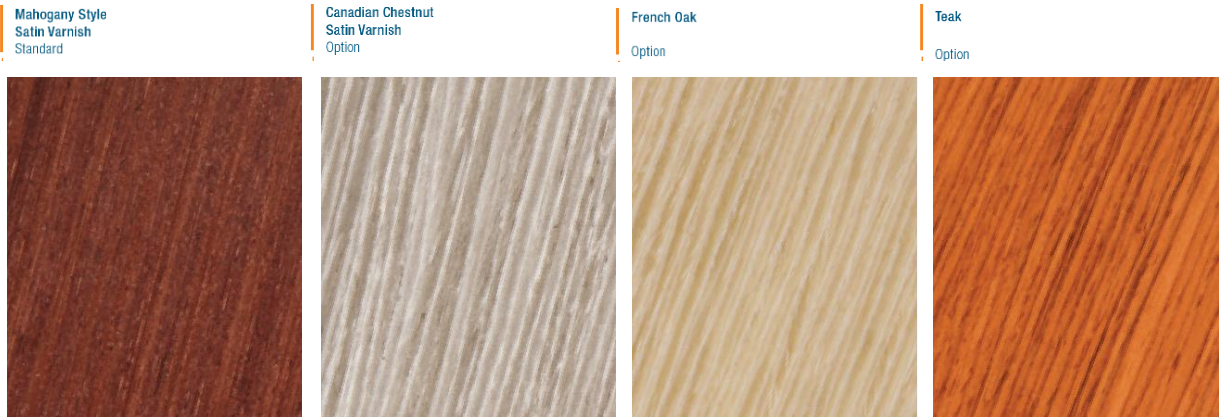

Floorboards:



Work Tops:

Black Quartz



Off White

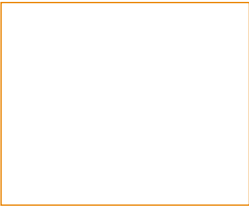

Well-known, well-received and proven, here are the products from our sample book

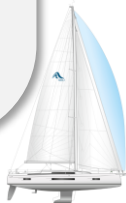





The new Hanse 410 and its competitors

Model	Bavaria C42	Hanse 418	Jeanneau Sun Odyssey 410	Océanis 40.1	Dufour 41	Hanse 410	Dufour 430	Sun Odyssey 440
Designer	Maurizio Cossutti	J&V	Marc Lombard	Marc Lombard	Umberto Felci Ardizio Design	Berret - Racoupeau Berret - Racoupeau	Umberto Felci	Philippe Briand Design Office Jeanneau
First built hull	2020	2017	2018	2020	2023	2023	2019	2017
Last built hull	Still in production	Still in production	Still in production	Still in production	Launch	Launch	Still in production	Still in production
Helm	2 wheels	2 wheels	2 wheels	2 wheels	2 wheels	2 wheels	2 wheels	2 wheels
Rudder	1 spade rudder	1 spade rudder	2 spade rudders	2 spade rudders	1 spade rudder	1 spade rudder	1 spade rudder	2 spade rudders
EC certification	A	A	A	A	A	A	A	A
Standard public price ex. VAT	218.300,00 €	215.900,00 €	232.400,00 €	229.800,00 €	230.000,00 €	251.900,00 €	257.805,00 €	274.500,00 €
Main dimensions								
Length overall	12,38	12,4	12,35	12,87	12,75	12,55	13,24	13,39
Hull length	11,98	11,99	11,99	11,99	11,99	11,99	12,5	12,64
Waterline length	11,27	10,4	11,71	11,7	11,2	11,55	11,69	12
Beam (width)	4,29	4,17	3,99	4,18	4,3	4,29	4,3	4,29
Draft	2,1	2,07	2.14 / 1.6 m	2,18	2,1	2,1	2,1	2,2
Draft	1,7	1,74		1,68		1,7	1,75	
Mast height from DWL	20,1	19,6	17,7	18,33		19,99		
Light displacement	9678	10100	7784	8180		9680	9700	8561
Ballast weight	2698	3200	2003	2007	2600	2545	2600	2280
Rig and sails								
Upwind sail area	100,6	87	77,1	61,6		84	92	90.3
Downwind sail area		172.5	42.8			169		127
Mainsail area	53,8	52.5	34.3	42,4		49	52	45.15
Jib area		34.5				35		81.85
Genoa area	46,8			34,3		43	40	45.15
Asymmetric spinnaker area	140	120				120		
Auxiliary engine								
Engine	40HP / 57 HP	39 HP / 57 HP	40 HP / 45 HP	45 HP	50	39 HP / 57 HP	50 HP / 60 HP	45 HP / 57 HP
Typ	Saildrive	Saildrive		Shaft Drive		Saildrive		
Fuel type	Diesel	Diesel	Diesel	Diesel	Diesel	Diesel	Diesel	Diesel
Fuel tank capacity	210 liters	160 liters	200 liters	195 liters	250 liters	160 liters	250 liters	200 liters
Fresh water tank capacity	210 / 460 liters	475 liters	530 liters	235 liters	250 liters	295 liters	430 liters	330 liters
Water heater capacity	20 liters	20 liters	40 liters	20 liters		22 liters		40 liters
Holding tank capacity	70 liters / Toilett	65 liters	80 liters	50 liters		65 liters		100 liters
Fridge/ice-box capacity	110 liters	130 liters	190 liters	190 liters		135 / 140 / 70 liters		130 liters

06 2023

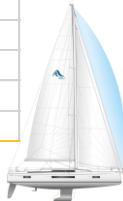





B2C Launch Roadmap

PRE-LAUNCH Hanse 410

- Teasing Brochure: May 5th 2023 uploaded in the MIS
- Hanse Social Media: May 8th 2023 one post in social media
- Press Teaser: May 8th 2023



LAUNCH Hanse 410

- Website launch: July 27th 2023
- Press announcement: July 27th 2023
- Hanse Social Media: July 27th 2023 weekly posts in the social media
- World premiere: Cannes Boat Show (boat in water)
- Availability of full brochure: January 2nd 2024 planned upload on MIS
- Serial production availability: January 2024 (start)





